

- REGION OF PEEL NOTES:**
1. ALL MATERIALS AND CONSTRUCTION METHODS MUST CORRESPOND TO THE CURRENT PEEL PUBLIC WORKS STANDARDS AND SPECIFICATIONS.
 2. WATERMAIN AND/OR WATER SERVICE MATERIALS 100mm# AND LARGER MUST BE PVC DR-18 PER AWWA C900-16. SIZE 50mm# AND SMALLER MUST BE SFT COPPER TYPE "K" PER ASTM B88-09.
 3. WATERMAIN AND/OR SERVICES ARE TO HAVE A MINIMUM COVER OF 1.0m WITH A MINIMUM HORIZONTAL SPACING OF 1.2m FROM THEMSELVES AND ALL OTHER SERVICES.
 4. PROVISIONS FOR FLUSHING WATER LINE PRIOR TO TESTING, ETC. MUST BE PROVIDED WITH AT LEAST A 50mm# OUTLET ON 100mm# AND LARGER LINES. COPPER LINES ARE TO HAVE FLUSHING POINTS AT THE END, THE SAME SIZE AS THE LINE. THEY MUST ALSO BE HOLED OR PIPES TO ALLOW WATER TO DRAIN ONTO A PARKING LOT OR DOWN A DRAIN. ON FIRE LINES, FLUSHING OUTLET TO BE 100mm# MINIMUM ON A HYDRANT.
 5. ALL CURB STOPS TO BE 3.0m OFF THE FACE OF THE BUILDING UNLESS NOTED OTHERWISE.
 6. HYDRANT AND VALVE SET TO REGION STANDARD 1-6-1 DIMENSION "A" (0.7m) & "B" (0.9m) AND TO HAVE PLUMBER NOZZLE.
 7. WATERMANS TO BE INSTALLED TO GRADES SHOWN ON APPROVED SITE PLAN. COPY OF GRADE SHEET MUST BE SUPPLIED TO INSPECTOR PRIOR TO COMMENCEMENT OF WORK, WHERE REQUESTED BY INSPECTOR.
 8. WATERMANS MUST HAVE A VERTICAL CLEARANCE OF 0.3m OVER AND 0.3m UNDER SEWERS AND ALL OTHER UTILITIES WHEN CROSSING.
 9. ALL PROPOSED WATER PIPING MUST BE ISOLATED FROM EXISTING LINES IN ORDER TO ALLOW INDEPENDENT PRESSURE TESTING AND CHLORINATING FROM EXISTING SYSTEMS.
 10. ALL LIVE TAPPING AND OPERATION OF REGION WATER VALVES SHALL BE ARRANGED THROUGH THE REGIONAL INSPECTOR ASSIGNED, OR BY CONTACTING THE OPERATIONS AND MAINTENANCE DIVISION.
 11. LOCATION OF ALL EXISTING UTILITIES IN THE FIELD TO BE ESTABLISHED BY THE CONTRACTOR.
 12. THE CONTRACTOR(S) SHALL BE SOLELY RESPONSIBLE FOR LOCATES, EXPOSING, SUPPORTING AND PROTECTING OF ALL UNDERGROUND/OVERHEAD UTILITIES AND STRUCTURES EXISTING AT THE TIME OF CONSTRUCTION IN THE AREA OF THEIR WORK, WHETHER SHOWN ON THE PLANS OR NOT, AND FOR ALL REPAIRS AND CONSEQUENCES RESULTING FROM DAMAGE TO SAME.
 13. THE CONTRACTOR(S) SHALL BE SOLELY RESPONSIBLE TO GIVE 72 HRS WRITTEN NOTICE TO UTILITIES PRIOR TO CROSSING SUCH UTILITIES, FOR THE PURPOSE OF INSPECTION BY THE CONCERNED UTILITY. THIS INSPECTION WILL BE FOR THE DURATION OF THE CONSTRUCTION, WITH THE CONTRACTOR RESPONSIBLE FOR ALL COSTS ARISING FROM SUCH INSPECTION.
 14. ALL PROPOSED WATER PIPING MUST BE ISOLATED THROUGH A TEMPORARY CONNECTION THAT SHALL INCLUDE AN APPROPRIATE CROSS-CONNECTION CONTROL DEVICE, CONSISTENT WITH THE DEGREE OF HAZARD, FOR BACKFLOW PREVENTION OF THE ACTIVE DISTRIBUTION SYSTEM, CONFORMING TO REGION OF PEEL STANDARDS 1-7-7 OR 1-7-8.

**TOWN OF CALEDON
PLANNING
RECEIVED**
March 28, 2024

SEE DWG. SS1

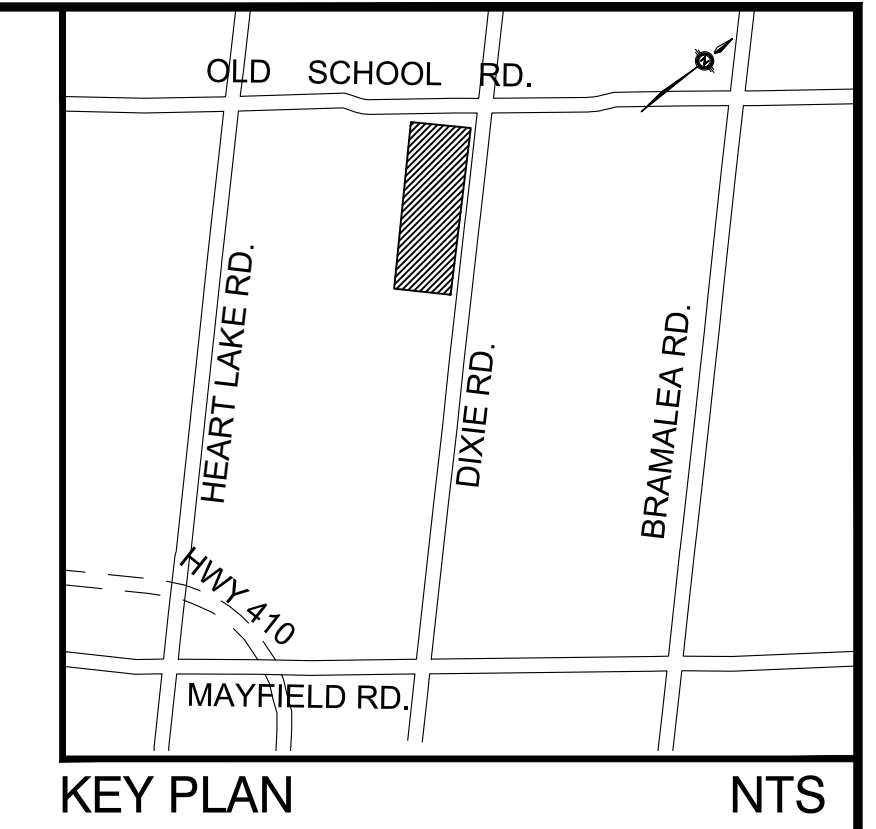

- LEGEND**
- ⊗ EX. VC EXISTING VALVE & CHAMBER
 - ⊕ EX. HYD. EXISTING HYDRANT
 - EX. SAN. MH EXISTING SANITARY MANHOLE
 - EX. STM. MH EXISTING STORM MANHOLE
 - CB EXISTING CATCHBASIN
 - SANITARY MANHOLE
 - STORM MANHOLE
 - CB CATCHBASIN
 - CB DOUBLE CATCHBASIN
 - ⊗ V&B VALVE AND BOX
 - ⊕ H&V HYDRANT AND VALVE
 - — — — — PROPERTY LINE

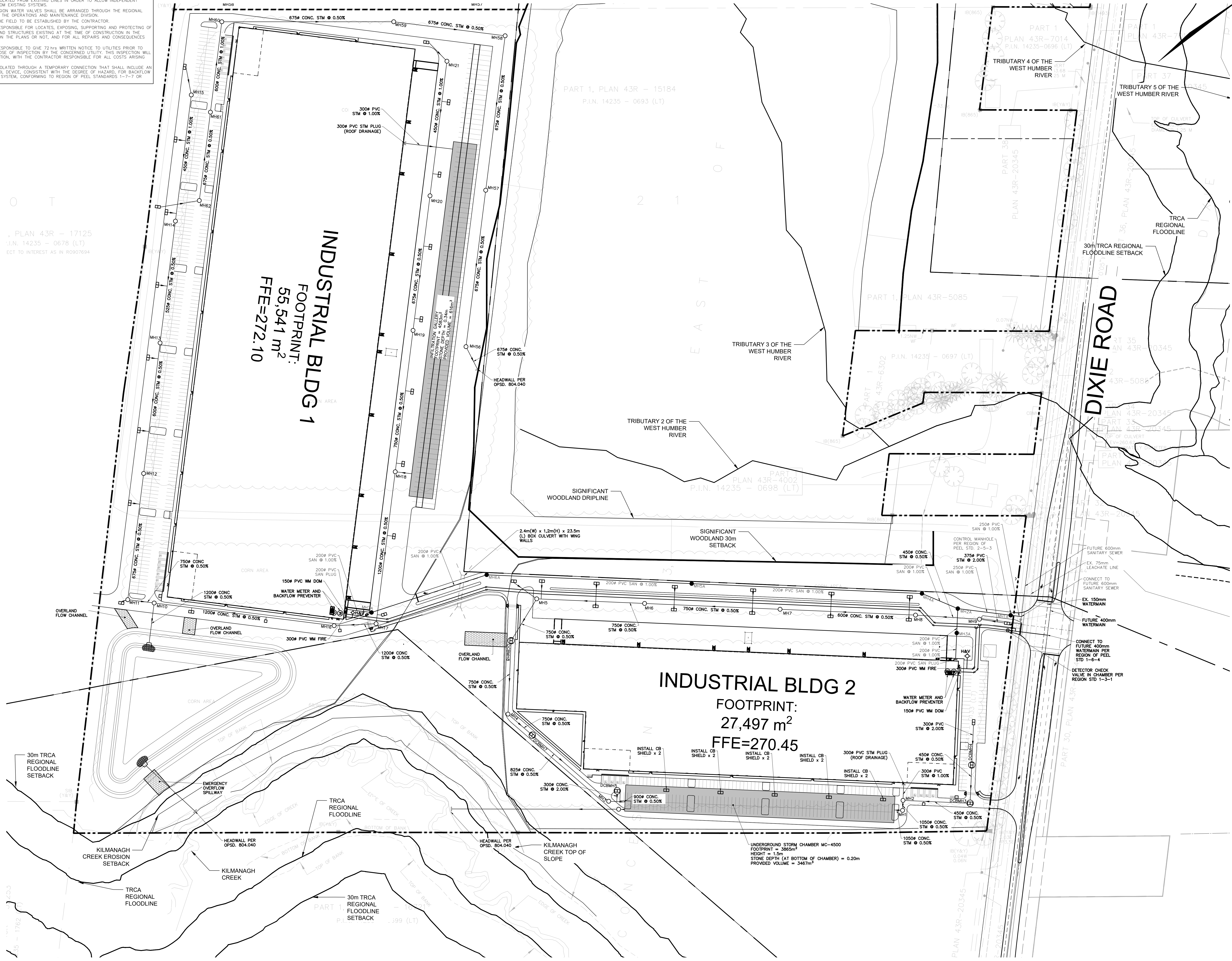

PRELIMINARY

1	ISSUED FOR O.P.A. / Z.B.A.	D.A.	FEB. 28/24
NO.	REVISIONS TO DRAWING	BY	DATE
ALL PREVIOUS ISSUES OF THIS DRAWING ARE SUPERSEDED. APPR.			
CLIENT QUADREAL PROPERTY GROUP LIMITED & TRIBAL PARTNERS CANADA INC.			
MUNICIPALITY TOWN OF CALEDON			
PROJECT TITLE 12668 & 12862 DIXIE ROAD			
SHEET TITLE SITE SERVICING PLAN			
CONSULTANT wsp			
100 Commerce Valley Dr. West, Thornhill, ON, Canada L3T 0A1 9 050-862-1100 2 880-862-0900 www.wsp.com			
DESIGNED	DRAWN	CHECKED	
D.A.	E.K.	D.A.	
SCALE	1:1000	DATE	FEBRUARY 2024
PROJECT NUMBER	201-11545	DWG. NUMBER	SS2

1:20240215 12668 & 12862 DIXIE ROAD - SITE SERVICING PLAN - SS2 - DWG. NO. 201-11545-SS2 - WSP