

- GENERAL NOTES**
- The contractor is responsible to ensure all construction staging areas, stockpiling, construction traffic and vehicular access does not occur within the Tree Protection Zones.
  - Prior to the commencement of any site activity the tree protection barriers specified on this plan must be installed and written notice provided to the City of Toronto.
  - Tree Protection Barriers must remain in effective condition until all site activities are complete.
  - Written notice must be provided and approved by the City of Toronto prior to removal of any Tree Protection Barriers.
  - The Contractor shall verify all dimensions and immediately inform the Consulting Arborist of any discrepancies between the information on the drawings and the actual conditions. Written approval must be obtained prior to proceeding.
  - The Contractor is responsible to examine the site, tree, plant and soil conditions prior to commencing work. Written notification to the Consulting Arborist must be provided of any conditions that may impact the successful tree protection measures outlined on this plan and in the approved Arborist Report.
  - The Contractor will coordinate with all other work/trades that may impact the completion of all work associated to the tree protection measures on this plan and outlines in the approved Arborist Report.

- TREE PROTECTION PLAN NOTES**
- Prior to site disturbance, the owner must confirm that no migratory birds are making use of the site for nesting. The owner must ensure that works are in conformance with the Migratory Bird Convention Act and that no migratory bird nests will be impacted by the proposed development.
  - It is the applicants' responsibility to discuss potential impacts to trees located near or wholly on adjacent properties or on shared boundary lines with their neighbours. Should such trees be injured to the point of instability or death the applicant may be held responsible through civil action.
  - All existing trees which are to remain shall be protected with fencing erected around the entire perimeter of the Tree Protection Zone as dictated on the Tree Preservation Plan.
  - Areas within the protective fencing shall remain undisturbed and shall not be used for the storage of building materials or equipment.
  - This work shall be completed, to the satisfaction of the City of Toronto, prior to site development. The developer or his/her agent shall take every precaution necessary to prevent damage to trees to be retained.
  - No rigging cables shall be wrapped around or installed in trees; and surplus soil, equipment, debris or materials shall not be placed over root systems of the

- trees within the protective fencing. No contaminants will be dumped or flushed where feeder roots of trees exist.
- Where limbs or portions of trees are removed to accommodate construction work, they will be carefully removed by an Arborist qualified in the Province of Ontario or an ISA Certified Arborist.
  - Where root systems of protected trees are exposed directly adjacent to or damaged by construction work, they shall be trimmed nearby by a qualified arborist and the area back filled with appropriate material to prevent desiccation.
  - An ISA certified Arborist or Arborist qualified in the Province of Ontario shall be on site for any work which impacts any tree or Tree Protection Zone.

- SITE PREPARATION**
- All trees to be Removed shall be flagged with orange fluorescent tape or spray paint around the entire circumference of the tree. The Consulting Arborist shall sign off on the trees marked for removal on-site.
  - All trees to be Preserved shall be flagged with white tape or spray paint around the entire circumference of the tree. The Consulting Arborist shall sign off on the trees marked for preservation.

- TREE PROTECTION BARRIERS**
- The required Tree Protection Barriers shall be constructed out of 1.2 meter (4 feet) high plywood sheets installed on 2x4 frames. Where plywood fencing creates a restriction to sightlines, orange plastic snow fencing installed on 2x4 frames can be used.
  - Tree Protection Barriers are to be erected prior to the commencement of any demolition, construction or grading activities on the site and are to remain in place for the duration of the development.
  - Tree Protection Barriers shall be maintained erect, in good repair and in effective condition throughout the duration of construction.
  - All supports and bracing used to secure the Tree Protection Barriers should be located outside of the Tree Protection zone to minimize damage to tree roots.
  - No materials or fill may be stored within the Tree Protection Zone.
  - Equipment or vehicles shall not be stored within the Tree Protection Zone.
  - No construction activity, grade changes, surface treatments, flushing of equipment or materials, or excavations of any kind is permitted within the Tree Protection Zone.

**DRAWING NOTES**  
 1. TAG NUMBERS MARKED WITH AN ASTERISK (\*) HAVE NOT BEEN LOCATED BY AN ONTARIO LAND SURVEYOR, THEIR LOCATIONS HAVE BEEN APPROXIMATED.  
 2. FOR CLARITY, MINIMUM REQUIRED TPZs HAVE NOT BEEN ADDED TO TREES LOCATED WITHIN THE CENTRAL PORTION OF THE SUBJECT SITE.

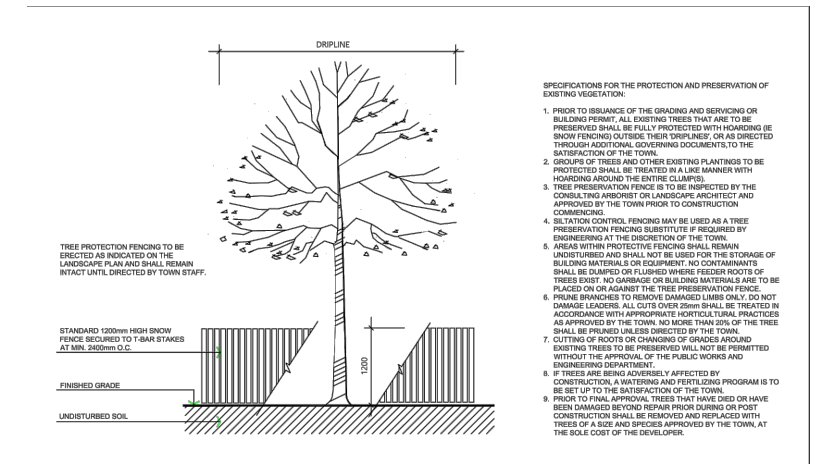

TOWN OF CALEDON	NO.	REVISION	APPROVED DATE	STANDARD NO.
TREE PRESERVATION	NO.	REVISION	APPROVED DATE	STANDARD NO. 698

TOWN OF CALEDON	NO.	REVISION	APPROVED DATE	STANDARD NO.
TREE PRESERVATION	NO.	REVISION	APPROVED DATE	STANDARD NO. 710

TOWN OF CALEDON	NO.	REVISION	APPROVED DATE	STANDARD NO.
TREE PRESERVATION	NO.	REVISION	APPROVED DATE	STANDARD NO. 711

**TREE INVENTORY AND PRESERVATION RECOMMENDATIONS**

TAG #	COMMON NAME	LATIN BINOMIAL	DBH (cm)	HT. (m)	TPZ (m)	Cat.	CONDITION	% CONDITION RATING	REMARKS	RECOMMENDATIONS
291	Black Walnut	Juglans nigra	25	1.8	SL	Very Good	85	Misshapen trunk	REMOVE Conflicts with proposed walkway	
292	Green Ash	Fraxinus pennsylvanica	45	3.0	SL	Very Poor	10	Infested with Emerald Ash Borer	REMOVE Condition warrants removal	
293	Sugar Maple	Acer saccharum	17	1.8	SL	Good	60	Pruning stubs; suppressed crown	REMOVE Conflicts with proposed parking area	
294	Manitoba Maple	Acer negundo	17	1.8	SL	Fair	50	Listing to the northwest; deadwood throughout crown	REMOVE Conflicts with proposed parking area	
295	Manitoba Maple	Acer negundo	16 x 14 x 11	1.8	SL	Fair	50	Listing to the northwest; deadwood throughout crown; vines in crown	REMOVE Conflicts with proposed parking area	
296	Manitoba Maple	Acer negundo	17	1.8	SL	Fair	50	Listing to the northwest; deadwood throughout crown; vines in crown	REMOVE Conflicts with proposed parking area	
297	Manitoba Maple	Acer negundo	31	2.4	SL	Very Poor	10	Snag at 2.5 metres; decaying; epicormic branching only	REMOVE Conflicts with proposed grading	
298	Manitoba Maple	Acer negundo	54	3.6	SL	Very Poor	15	Bark sloughed off western to northern sides of bole; large deadwood; large scaffold has failed onto Tree #299	REMOVE Conflicts with proposed grading	
299	Manitoba Maple	Acer negundo	21 x 18	1.8	SL	Very Poor	20	2 stems from base; basal decay; extensive deadwood	REMOVE Conflicts with proposed driveway	
300	Black Walnut	Juglans nigra	89	6.0	PP	Very Good	85	Minor deadwood; stubs; on property to the northwest	PRESERVE & PROTECT Install TPZ fencing	
301	White Cedar	Thuja occidentalis	31	2.4	PP	Poor	30	Wounded on west side; top has died back on both co-dominant leaders; on adjacent property to the north/boundary line	RETAIN	
302	White Cedar	Thuja occidentalis	28	1.8	PP	Poor	40	Wounded but sealed on west side of bole; leaning to the southwest; multiple dominant leaders; suppressed crown.	RETAIN	
303	White Cedar	Thuja occidentalis	47	3.0	PP	Good	60	Large longitudinal wound on west side; decay at root crown	REMOVE Conflicts with proposed grading Consent required to remove tree on adjacent private property	
304	White Cedar	Thuja occidentalis	49	3.0	PP	Good	60	Woodpecker damage on west side of bole; hollow sounding	REMOVE Conflicts with proposed grading Consent required to remove tree on adjacent private property	
305	Manitoba Maple	Acer negundo	49	3.0	SL	Poor	40	Leaning to the northeast; extensive epicormic branching; large deadwood	REMOVE Conflicts with proposed driveway	
413	White Cedar	Thuja occidentalis	34	2.4	SL	Very Good	90		REMOVE Conflicts with proposed parking area	
414	White Spruce	Picea glauca	54	3.6	SL	Very Good	90	Imbalanced crown	REMOVE Conflicts with proposed parking area	
415	White Spruce	Picea glauca	38	2.4	SL	Very Good	90	Imbalanced crown	REMOVE Conflicts with proposed parking area	
416	Sugar Maple	Acer saccharum	38	2.4	SL	Very Good	90	Included bark at main crotch	REMOVE Conflicts with proposed parking area	
417	Manitoba Maple	Acer negundo	39 x 34	4.8	SL	Good	70	Co-dominant stems with included bark at main crotch; crown is imbalanced to the west; minor deadwood in crown	REMOVE Conflicts with proposed parking area	
418	Balsam Fir	Abies balsamea	49	3.0	SL	Very Good	90	Excellent form	REMOVE Conflicts with proposed driveway	
419	Colorado Blue Spruce	Picea pungens cv.	13	1.8	SL	Good	65	Hedgerow; crown lifted; crown suppressed due to shading; this crown	REMOVE Conflicts with proposed parking area	
420	Colorado Blue Spruce	Picea pungens cv.	16	1.8	SL	Fair	50	Hedgerow; top failed and secondary leader established	REMOVE Conflicts with proposed parking area	
421	Colorado Blue Spruce	Picea pungens cv.	21	1.8	SL	Fair	50	Hedgerow; suppressed crown; crown lifted	REMOVE Conflicts with proposed driveway	
422	Colorado Blue Spruce	Picea pungens cv.	16	1.8	SL	Fair	50	Hedgerow; suppressed crown; crown lifted	REMOVE Conflicts with proposed driveway	
423	Colorado Blue Spruce	Picea pungens cv.	15	1.8	SL	Fair	50	Hedgerow; suppressed crown; crown lifted	REMOVE Conflicts with proposed driveway	
424	Colorado Blue Spruce	Picea pungens cv.	22	1.8	SL	Fair	50	Hedgerow; suppressed crown; crown lifted	REMOVE Conflicts with proposed driveway	
425	Colorado Blue Spruce	Picea pungens cv.	20	1.8	SL	Fair	50	Hedgerow; suppressed crown; crown lifted	REMOVE Conflicts with proposed grading	
426	Colorado Blue Spruce	Picea pungens cv.	28	1.8	SL	Fair	50	Hedgerow; suppressed crown; crown lifted	REMOVE Conflicts with proposed grading	
427	Colorado Blue Spruce	Picea pungens cv.	23	1.8	SL	Fair	50	Hedgerow; suppressed crown; crown lifted	REMOVE Conflicts with proposed grading	
428	Colorado Blue Spruce	Picea pungens cv.	25	1.8	SL	Fair	50	Hedgerow; suppressed crown; crown lifted	REMOVE Conflicts with proposed grading	
429	Colorado Blue Spruce	Picea pungens cv.	21	1.8	SL	Fair	50	Hedgerow; suppressed crown; crown lifted	REMOVE Conflicts with proposed grading	
430	Colorado Blue Spruce	Picea pungens cv.	15	1.8	SL	Fair	50	Hedgerow; suppressed crown; crown lifted	REMOVE Conflicts with proposed grading	
431	Colorado Blue Spruce	Picea pungens cv.	24	1.8	SL	Fair	50	Hedgerow; suppressed crown; crown lifted	REMOVE Conflicts with proposed grading	
432	Colorado Blue Spruce	Picea pungens cv.	24	1.8	SL	Good	65	Hedgerow; suppressed crown; crown lifted	REMOVE Conflicts with proposed grading	
433	Manitoba Maple	Acer negundo	29	1.8	SL	Fair	60	Leaning to the south; small crown with deadwood throughout	REMOVE Conflicts with proposed parking area	
434	Manitoba Maple	Acer negundo	33 x 21	3.6	SL	Poor	25	2 stems from grade; leaning to south; extensive deadwood throughout; small cavity at base of 33cm dia. stem with potential butt rot/decay	REMOVE Conflicts with proposed parking area	
435	Manitoba Maple	Acer negundo	24 x 23 x 18	4.2	SL	Poor	40	3 stems from grade; 18cm dia. stem leaning to the west; deadwood throughout the crown	REMOVE Conflicts with proposed parking area	
436	Manitoba Maple	Acer negundo	15	1.8	SL	Poor	30	Suppressed crown with deadwood throughout	REMOVE Conflicts with proposed parking area	
437	Manitoba Maple	Acer negundo	51	3.6	SL	Poor	30	Large co-dominant stem has failed and large wound remains on northwest side of bole with decay/fuiling bodies present; deadwood throughout crown; crown imbalanced to the east	REMOVE Conflicts with proposed parking area	
438	Manitoba Maple	Acer negundo	22	1.8	SL	Very Poor	20	Leaning to the west; deadwood throughout crown	REMOVE Conflicts with proposed parking area	
439	Manitoba Maple	Acer negundo	22	1.8	SL	Very Poor	20	Originating from fallen stem with many new adventitious stems emerging	REMOVE Conflicts with proposed driveway	
440	Manitoba Maple	Acer negundo	37	2.4	SL	Poor	25	Branch dieback throughout crown; fuiling bodies (decay) on failed limb in crown	REMOVE Conflicts with proposed grading	
441	Black Walnut	Juglans nigra	13	1.8	SL	Good	80	Misshapen/suppressed crown due to shading *Not located by surveyor; location approximated	REMOVE Conflicts with proposed parking area	
442	Black Walnut	Juglans nigra	21	1.8	SL	Very Good	85	*Not located by surveyor; location approximated	REMOVE Conflicts with proposed parking area	
443	White Elm	Ulmus americana	35	2.4	SL	Good	75	Minor deadwood	REMOVE Conflicts with proposed parking area	
444	Black Walnut	Juglans nigra	19	1.8	SL	Very Good	90		REMOVE Conflicts with proposed parking area	
445	Manitoba Maple	Acer negundo	32 x 27	3.6	SL	Poor	40	2 stems; leaning to west; potential butt rot on east side of root crown; deadwood throughout crown	REMOVE Conflicts with proposed building	
446	Manitoba Maple	Acer negundo	33	2.4	SL	Very Poor	10	Snag with epicormic branching; fuiling bodies on bole	REMOVE Conflicts with proposed building	
447	White Spruce	Picea glauca	63	4.2	SL	Good	70	Co-dominant stem with included bark at main crotch; large defect on north side of scaffold just above crotch	REMOVE Conflicts with proposed building	
448	Manitoba Maple	Acer negundo	40	2.4	SL	Poor	40	Boundary tree located on shared northern boundary line Growing from base of Tree #447; large limb on northwest side with shear crack; minor deadwood	REMOVE Conflicts with proposed building	
449	White Spruce	Picea glauca	39	2.4	SL	Fair	60	Co-dominant stem with included bark at main crotch; thin crown at top with minor butt dieback	REMOVE Conflicts with proposed building	
450	Manitoba Maple	Acer negundo	38	2.4	SL	Very Poor	10	Snag with epicormic branching; cracked down centre of main bole	REMOVE Conflicts with proposed building	
451	Manitoba Maple	Acer negundo	44	3.0	SL	Very Poor	10	Boundary tree located on shared northern boundary line Snag with epicormic branching; leaning to the southeast	REMOVE Conflicts with proposed building	
452	Manitoba Maple	Acer negundo	36	2.4	SL	Fair	50	Growing to the north *Not located by surveyor; location approximated	REMOVE Conflicts with proposed building	

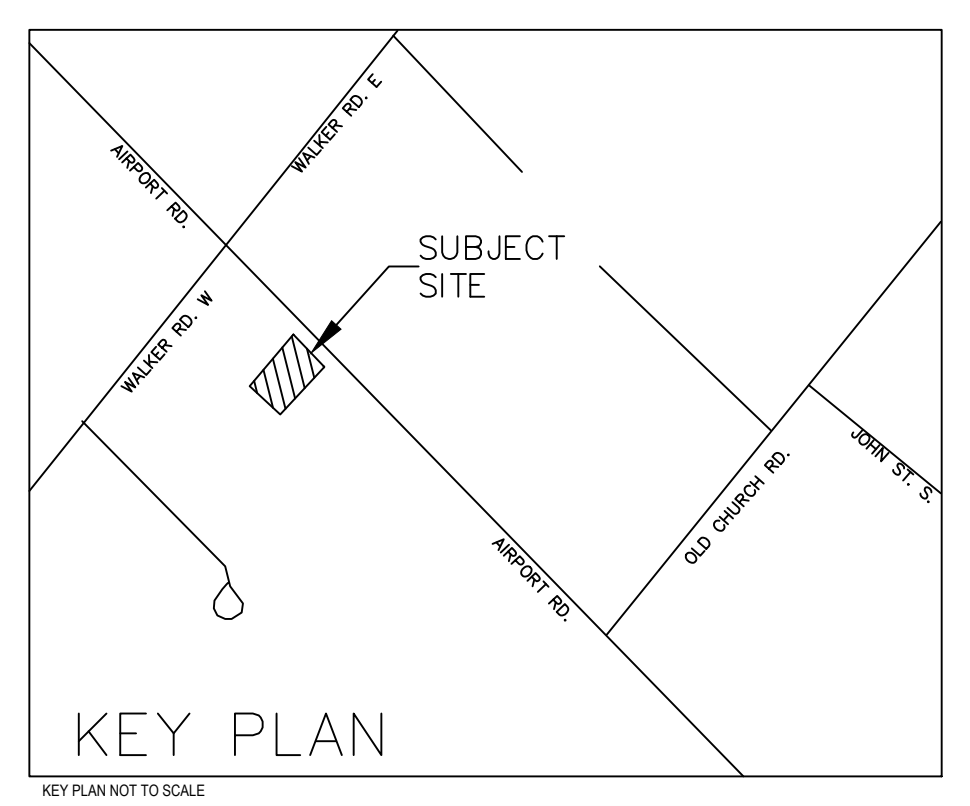

**7 OAKS**  
 TREE CARE &  
 URBAN FORESTRY CONSULTANTS INC.  
 P.O. BOX 2453 (STN. B) RICHMOND HILL, ON L4E 1A5  
 T: (905) 773-1733 E: INFO@7OAKSTREECARE.CA

- LEGEND**
- EXISTING DECIDUOUS TREE
  - EXISTING CONIFEROUS TREE
  - TREE TAG NUMBER & DIAMETER MEASUREMENT
  - MINIMUM TREE PROTECTION DISTANCE
  - TREE TO BE REMOVED
  - TREE PRESERVATION FENCING
  - SITE BOUNDARY

REV #	REVISION	DATE
01	UPDATED SITE/SP/SG	19/4/22
02	UPDATED SITE/SP/SG	22/2/22

TOWN FILE NOS:  
**POPA 19-07**  
**RZ 19-10**  
**SPA 19-66**

CLIENT  
**GANNI PROPERTIES INC.**

PROJECT  
**Tim Hortons**  
 16054, 16060 & 16068 AIRPORT ROAD  
 CALEDON, ONTARIO

TITLE  
**TREE PRESERVATION PLAN**

DATE: OCTOBER 2, 2019  
 PROJECT NO.: TA-19-027  
 DRAWN BY: LAS  
 SCALE: 1:150  
 PAGE: 1 OF 1

DRAWING NO. PROJECT NORTH

**TOWN OF CALEDON**  
**PLANNING**  
**RECEIVED**  
 June 21, 2022

THIS PLAN IS TO BE READ IN CONJUNCTION WITH THE ARBORIST REPORT AND TREE PRESERVATION PLAN AS PREPARED BY 7 OAKS TREE CARE & URBAN FORESTRY CONSULTANTS INC.

**TIPP - 01**