

ALBION VAUGHAN ROAD  
(ROAD ALLOWANCE BETWEEN TOWNSHIPS OF ALBION & VAUGHAN)  
PIN 03321-0094(LT)

CENTRELINE OF ORIGINAL ROAD ALLOWANCE

ROAD TRAFFIC LINE

146.91 m - N 24°10'20" W

146.91 m - N 24°10'20" W

PART 3, PLAN 43R-3146

PART 4, PLAN 43R-33446

PROPOSED STREET WIDENING (SUBJECT TO CHANGE UPON REVIEW BY PUBLIC AUTHORITIES HAVING JURISDICTION)

PROPOSED 0.30 RESERVE

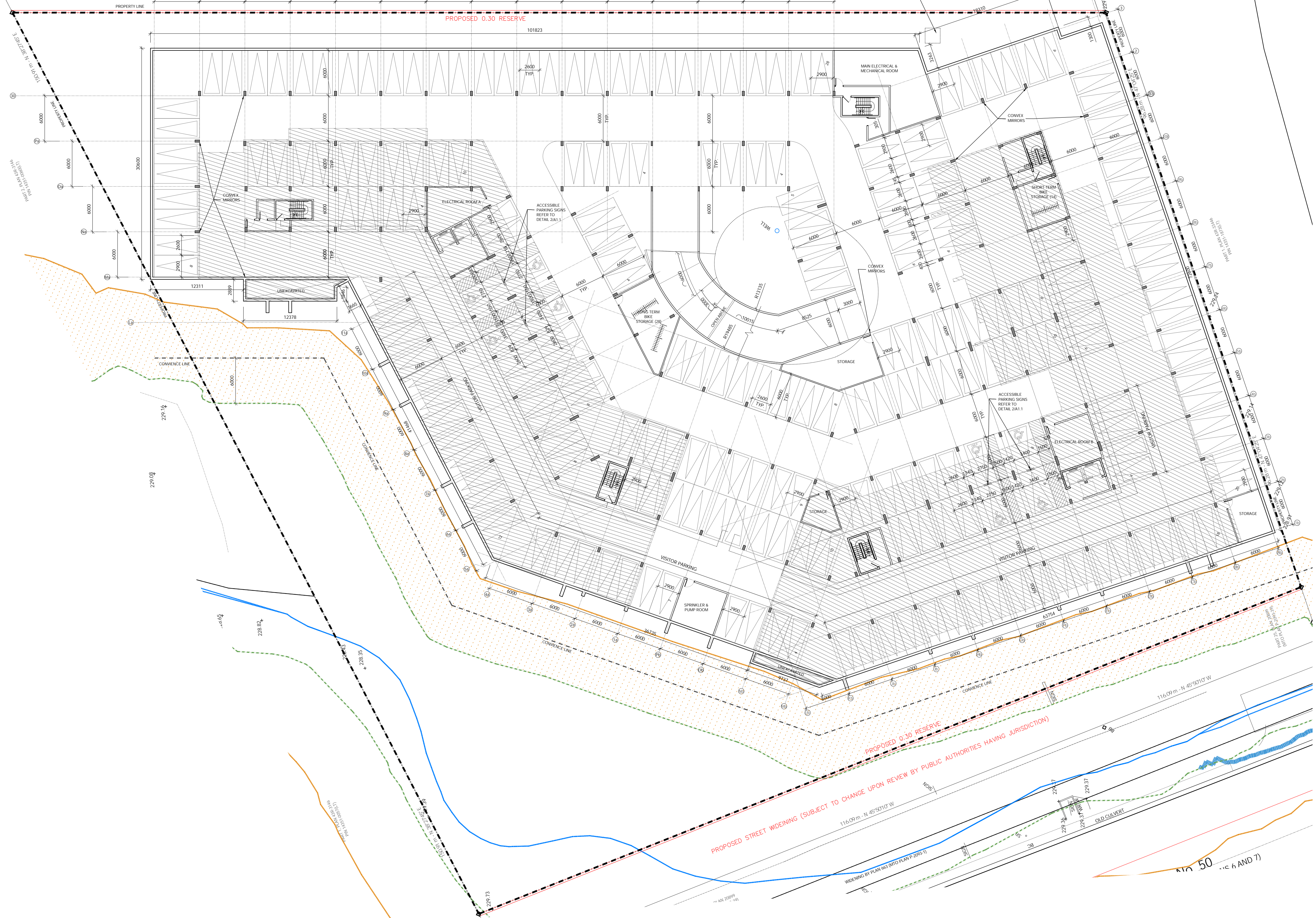

PARKING			
BY LAW - PARKING REQUIREMENTS			
CONDO UNITS PARKING SPACES	1.5 PARKING SPOTS PER DWELLING UNIT	398	
VISITOR - CONDO UNITS PARKING SPACE	0.25 PARKING SPACES PER UNIT FOR VISITOR PARKING IN A DESIGNATED VISITOR PARKING AREA	66	
ACCESSIBLE PARKING RECORDED C/P1 OF TOTAL - 2		11 240	
GRAND TOTAL PARKING REQUIRED			463 750
RESIDENT (ACCESSIBLE)	RESIDENT SPOTS	TOTAL	
P1 LEVEL	8	213	
P2 LEVEL	0	231	
GROUND SURFACE LEVEL	4	6	
GRAND TOTAL PARKING PROVIDED	12	450	462 spaces prov.

BICYCLE STORAGE			
	LONG TERM	SHORT TERM	TOTAL
GROUND SURFACE LEVEL			30
P1 LEVEL	28	28	
P2 LEVEL	28	28	
GRAND TOTAL BICYCLE STORAGE SPOTS	56	86	142

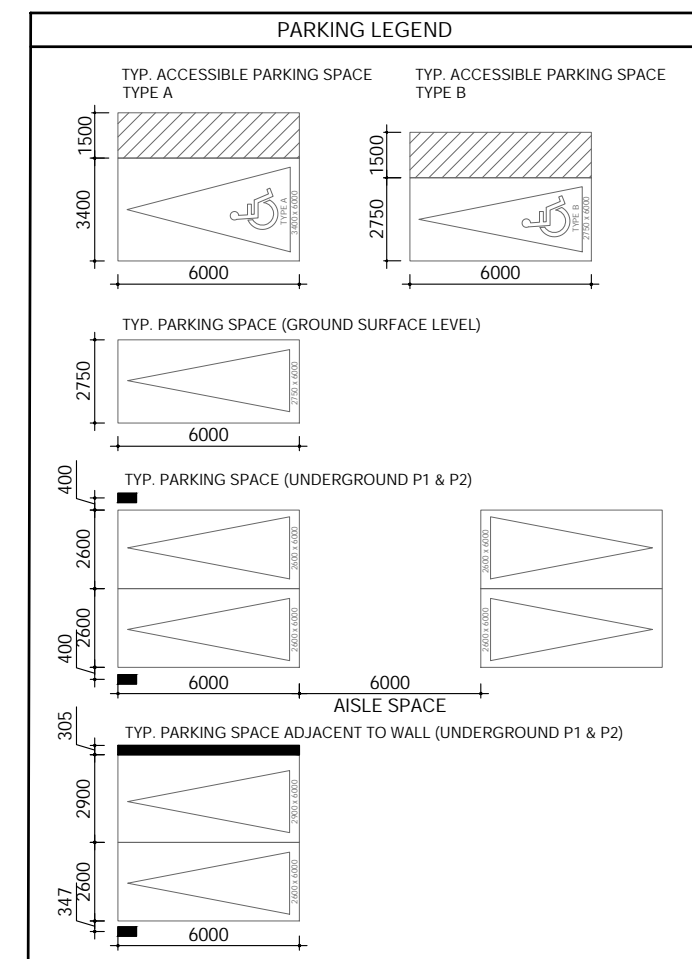

1 P1 LEVEL - PARKING TOWER A & B  
A2.0 SCALE: 1:250



KEY PLAN

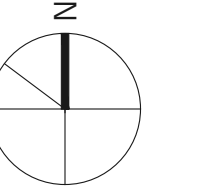

TOWN OF CALEDON  
PLANNING  
RECEIVED  
May 1, 2023

No.	REVISIONS	DATE
1	RE - ISSUED FOR SPA	2023-03-15

ISSUED FOR CONSTRUCTION  
ISSUED FOR BID  
ISSUED FOR BUILDING PERMIT  
ISSUED FOR SITE PLAN APPROVAL 2021-01-27

CONTRACTORS MUST CHECK AND VERIFY ALL DIMENSIONS AND CONDITIONS ON THE PROJECT AND MUST REPORT ANY DISCREPANCIES TO THE DESIGNER BEFORE PROCEEDING WITH CONSTRUCTION.  
THIS DRAWING MUST NOT BE USED FOR CONSTRUCTION PURPOSES UNLESS SIGNED AND SIGNED BY THE DESIGNER.  
DO NOT SCALE DRAWINGS.

**FCA**  
**FAUSTO CORTESE ARCHITECTS**  
3590 RUTHERFORD RD. UNIT 7  
VAUGHAN, ONTARIO, L4H 3T8  
416-806-7000  
FCORTESE@FCARCHITECTS.CA

PROPOSED MIX-USE CONDO DEVELOPMENT  
12148 ALBION VAUGHAN RD.  
BOLTON  
TOWN OF CALEDON

DATE	10/02/2023	PROJECT No.	2019-22
SCALE	AS NOTED	DRAWING No.	A2.0
DESIGNED BY	AD	REVIEWED BY	F.C.

FILE NAME: 12148VAUGHANRD\_A2.023-10-2023-10-2023