

TOWN OF CALEDON
PLANNING
RECEIVED

May 1, 2023

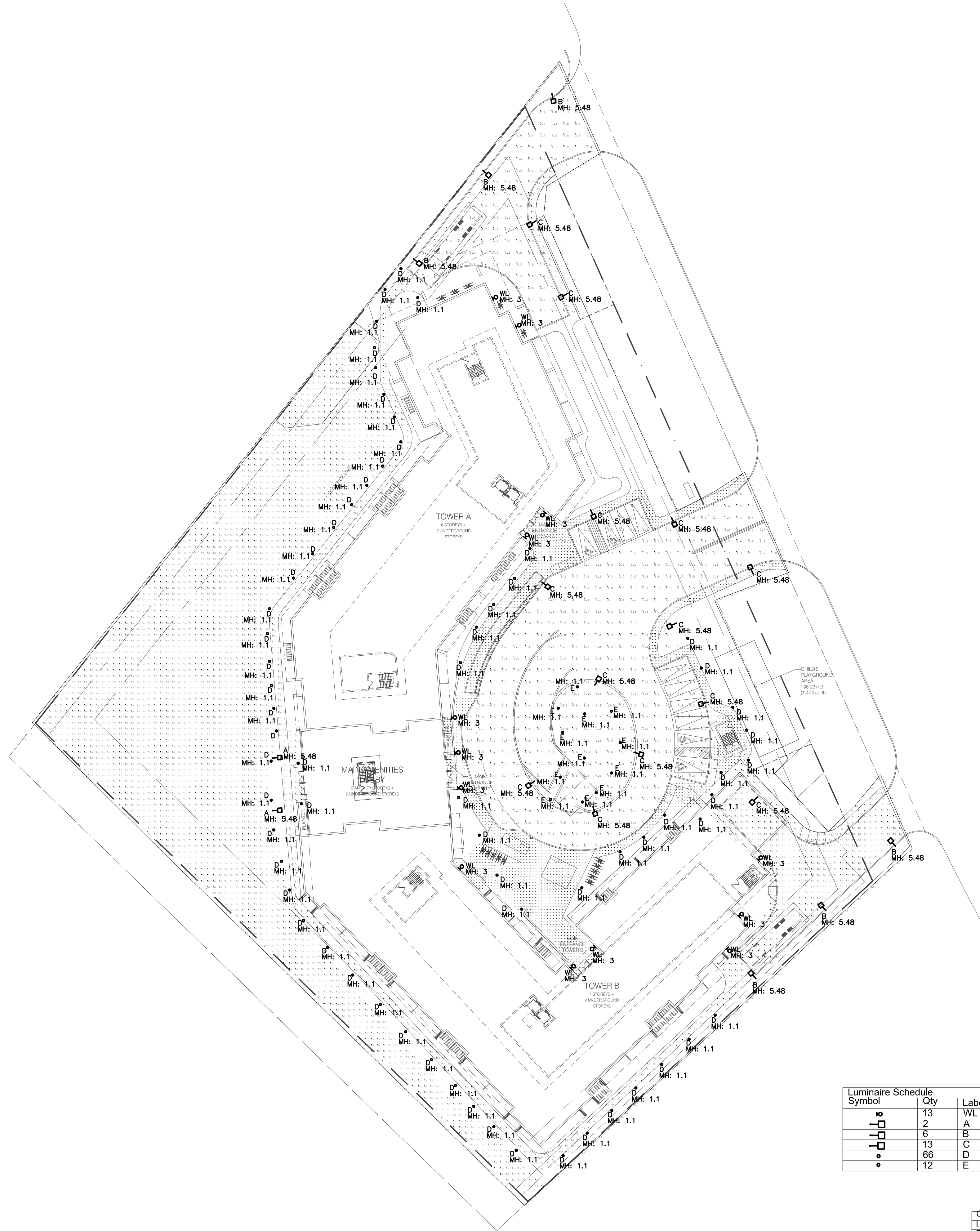

SITE PLAN
SCALE: 1:400

PROJECT: Proposed Mix-Used Condo Development - Site Lighting	
Fixture Schedule	
TYPE	DESCRIPTION
A	Single head pole mounted 4594 lumens, 3000K, 48W, Type II Distribution, 70CRI, Die-cast Aluminum housing, polyester powder coat finish. Fixture shall have one-piece silicone optics with a minimum transmittance of 93% and zero up light. Fixture 0-10V LED driver shall be over/under voltage, short circuit & over temperature protected in compliance with FCC standards and shall be suitable for -40°C to +50°C operation. Fixture shall be IP66 rated to IEC60598 and IK08 rated. L70 calculated life must be > 100K hrs as per IESNA TM-21 standards. Maximum candela beam shall be at 62.5° from nadir and shall not exceed 4868 candelas. Bug rating: B0-U0-G1. Finish to be confirmed by architect during shop drawing review. To be completed with 10kV surge protection. Mounting height: 5.48 m Mfr: LSI Lighting Mirada Medium Area Cat: MRM-LED-07L-SIL-3-30-70CRI-IL-STD FINISH
B	Single head pole mounted 5260 lumens, 3000K, 48W, Type III Distribution, 70CRI, Die-cast Aluminum housing, polyester powder coat finish. Fixture shall have one-piece silicone optics with a minimum transmittance of 93% and zero up light. Fixture 0-10V LED driver shall be over/under voltage, short circuit & over temperature protected in compliance with FCC standards and shall be suitable for -40°C to +50°C operation. Fixture shall be IP66 rated to IEC60598 and IK08 rated. L70 calculated life must be > 100K hrs as per IESNA TM-21 standards. Maximum candela beam shall be at 67.5° from nadir and shall not exceed 5709 candelas. Bug rating: B0-U0-G2. Finish to be confirmed by architect during shop drawing review. To be completed with 10kV surge protection. Mounting height: 5.48 m Mfr: LSI Lighting Mirada Medium Area Cat: MRM-LED-07L-SIL-3-30-70CRI-IL-STD FINISH
C	Single head pole mounted 7616 lumens, 3000K, 48W, Type III Distribution, 70CRI, Die-cast Aluminum housing, polyester powder coat finish. Fixture shall have one-piece silicone optics with a minimum transmittance of 93% and zero up light. Fixture 0-10V LED driver shall be over/under voltage, short circuit & over temperature protected in compliance with FCC standards and shall be suitable for -40°C to +50°C operation. Fixture shall be IP66 rated to IEC60598 and IK08 rated. L70 calculated life must be > 100K hrs as per IESNA TM-21 standards. Maximum candela beam shall be at 70° from nadir and shall not exceed 6338 candelas. Bug rating: B1-U0-G2. Finish to be confirmed by architect during shop drawing review. To be completed with 10kV surge protection. Mounting height: 5.48 m Mfr: LSI Lighting Mirada Medium Area Cat: MRM-LED-07L-SIL-3-30-70CRI-IL-STD FINISH
D	LED Bollard 1633 lumens, 3000K, 23W, Type V Distribution, Asymmetric, 70CRI, Die-cast Aluminum housing. Fixture 0-10V LED driver shall be over/under voltage, short circuit & over temperature protected in compliance with FCC standards and shall be suitable for -40°C to +50°C operation. Fixture shall be IP66 rated per IEC 60598. L91 calculated life must be > 100K hrs as per IESNA TM-21-11 standards. Maximum candela beam shall be at 52.5° from nadir and shall not exceed 705 candelas. Bug rating: B1-U1-G1. Finish to be confirmed by architect during shop drawing review. Mounting height: 1.1 m Mfr: LSI Lighting Mirada Bollard Cat: MRB-LED-25L-ACR-A-30
E	LED Bollard 2156 lumens, 3000K, 30.5W, Type IV Distribution, Symmetric, 70CRI, Die-cast Aluminum housing. Fixture 0-10V LED driver shall be over/under voltage, short circuit & over temperature protected in compliance with FCC standards and shall be suitable for -40°C to +50°C operation. Fixture shall be IP66 rated per IEC 60598. L91 calculated life must be > 100K hrs as per IESNA TM-21-11 standards. Maximum candela beam shall be at 55° from nadir and shall not exceed 865 candelas. Bug rating: B1-U2-G1. Finish to be confirmed by architect during shop drawing review. Mounting height: 1.1 m Mfr: LSI Lighting Mirada Bollard Cat: MRB-LED-25L-ACR-S-30
WL	LED Outdoor Wall Mounted luminaire, 963 lumens, 4000K, 11.47W, Type IV Distribution, Die-cast Aluminum baseplate with UV stabilized high impact lens with full reflector/wire cover of 92% reflectivity Std 0-10v Dimming. Maximum candela beam shall be at 65° from nadir and shall not exceed 960 candelas. Bug rating: B0-U3-G2 Mounting height: 3 m Mfr: Kenall Millennium Ovals for Architectural High Abuse Cat: MO13HL-PP-MW-8L40K-DCC-DV

Symbol	Qty	Label	Description	Lum. Watts	LLF	Lum. Lumens
○	13	WL	MO13HL-PP-MW-8L40K-DCC-DV	11.47	0.900	963
○	2	A	MRM-LED-07L-SIL-2-30-70CRI-IL	53	0.880	4167
○	6	B	MRM-LED-07L-SIL-3-30-70CRI-IL	53	0.880	5050
○	13	C	MRM-LED-07L-SIL-3-30-70CRI	53	0.880	6889
○	66	D	MRB-LED-25L-ACR-A-30	23	0.930	1633
○	12	E	MRB-LED-25L-ACR-S-30	30	0.930	2156

Calculation Summary						
Label	Units	Avg	Max	Min	Avg/Min	Max/Min
Back Sidewalk	Fc	6.51	18.2	0.3	21.70	60.67
Backside Landscape	Fc	0.53	13.6	0.0	N.A.	N.A.
Main Entrance Sidewalk1	Fc	3.15	19.0	0.0	N.A.	N.A.
Main Entrances Driveway	Fc	3.51	24.1	0.3	11.70	80.33
Property line	Fc	0.60	7.9	0.0	N.A.	N.A.
Tower A Service Entry Road	Fc	2.30	5.1	0.8	2.88	6.38
Tower A Service Road Side Walk	Fc	2.14	14.0	0.5	4.28	28.00
Tower B Service Entry Road	Fc	2.85	5.9	0.2	14.25	29.50
Tower B Service Road Side Walk	Fc	1.84	2.6	0.8	2.30	3.25

NOTES:

- REFER TO LAYOUT FOR LUMINAIRES MOUNTING HEIGHT
- POLE LUMINAIRES MOUNTING HEIGHT IS REAR FACE (TOP POLE AND 3' BASE)
- CALCULATION ORDS ARE AT GRADE LEVEL.

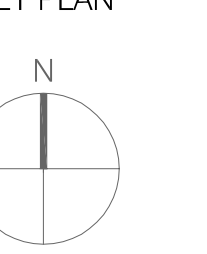
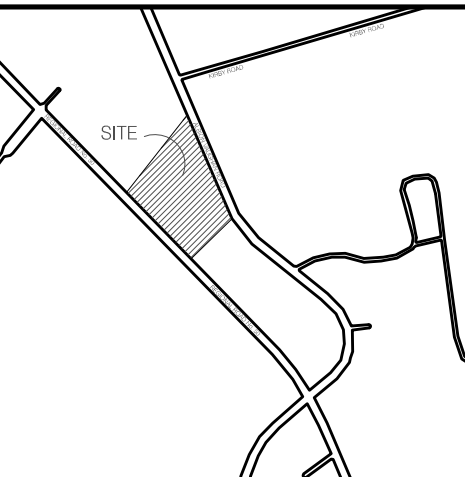

No.	DESCRIPTION	DATE

ISSUED FOR CONSTRUCTION
ISSUED FOR BID
ISSUED FOR BUILDING PERMIT
ISSUED FOR SITE PLAN APPROVAL
SUBMITTALS
CONTRACTORS MUST CHECK AND VERIFY ALL DIMENSIONS AND CONDITIONS ON THE PROJECT AND MUST REPORT ANY DISCREPANCIES TO THE DESIGNER BEFORE PROCEEDING WITH CONSTRUCTION.
THIS DRAWING MUST NOT BE USED FOR CONSTRUCTION PURPOSES UNTIL SEALED AND SIGNED BY THE DESIGNER.
DO NOT SCALE DRAWINGS.



PROPOSED MIX-USED CONDO DEVELOPMENT
12148 ALBION VAUGHAN RD
BOLTON
TOWN OF CALEDON

LIGHTING PHOTOMETRIC PLAN

DATE	PROJECT NO.
JAN 2023	2020-108
SCALE	DRAWING NO.
1:200	LE-1
DRAWN BY	REVIEWED BY