

**ESC PHASE 2 NOTES:**

- 1 CONDUCT EARTHWORKS OPERATIONS
- 2 RE-ALIGN CHANNEL AND STABILIZE BANKS WITH TERRAFIX
- 3 INSTALL ROCK CHECK DAMS AND EXCAVATE POOLS IN LOCATIONS AS SHOWN
- 4 REMOVE EXISTING ACCESS AND CULVERT
- 5 DECOMMISSION TEMPORARY DEWATERING PUMPING SYSTEM AND COFFER DAMS AND COMPLETE CHANNEL-REALIGNMENT PREVIOUSLY OBSTRUCTED BY THE DAM.
- 6 INSTALL RIFFLES AND REVETMENT
- 7 FINAL GRADING AND STABILIZATION
- 8 DECOMMISSION ALL REMAINING ESC MEASURES

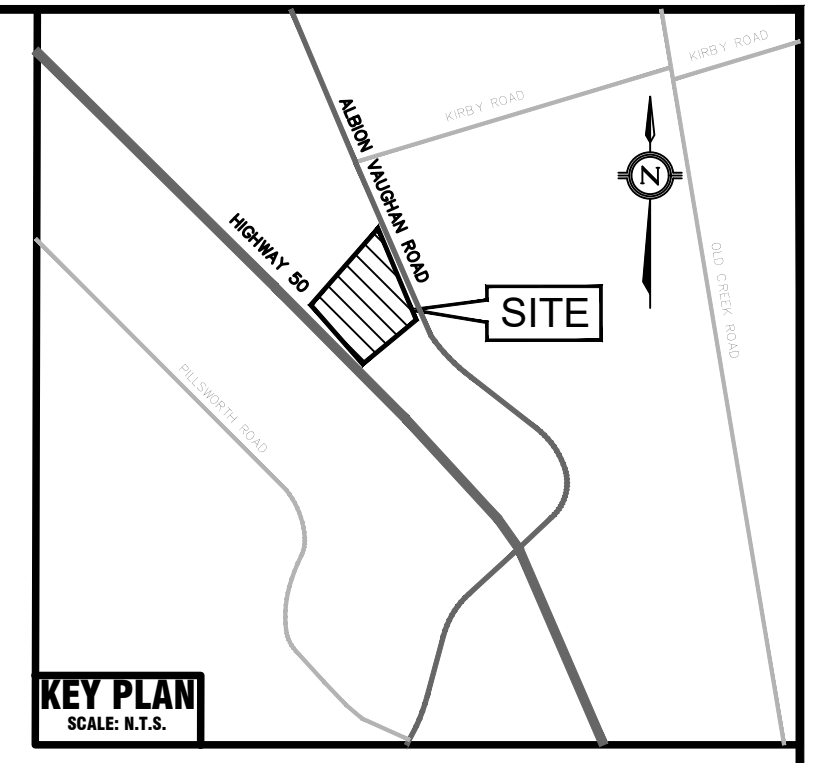

TOWN OF CALEDON  
PLANNING  
RECEIVED  
May 1, 2023

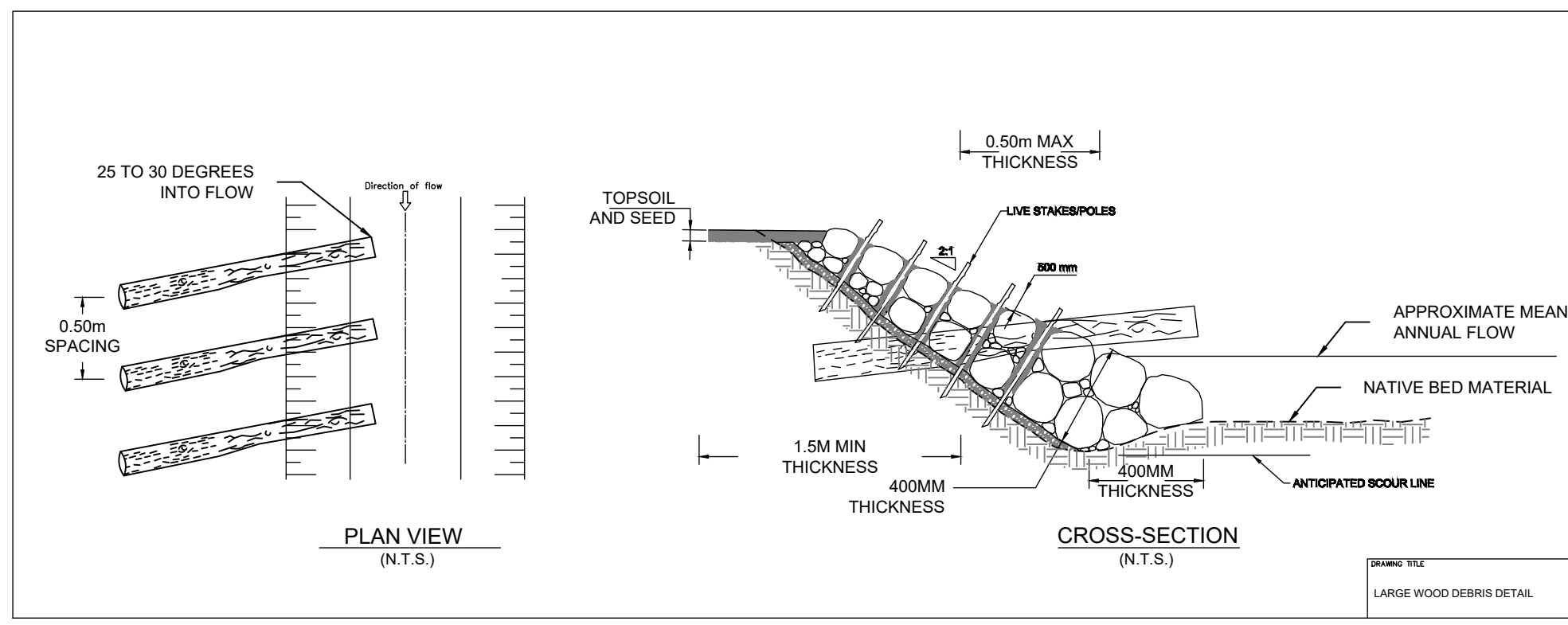
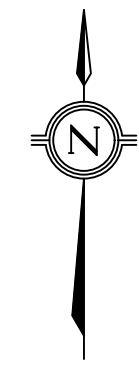
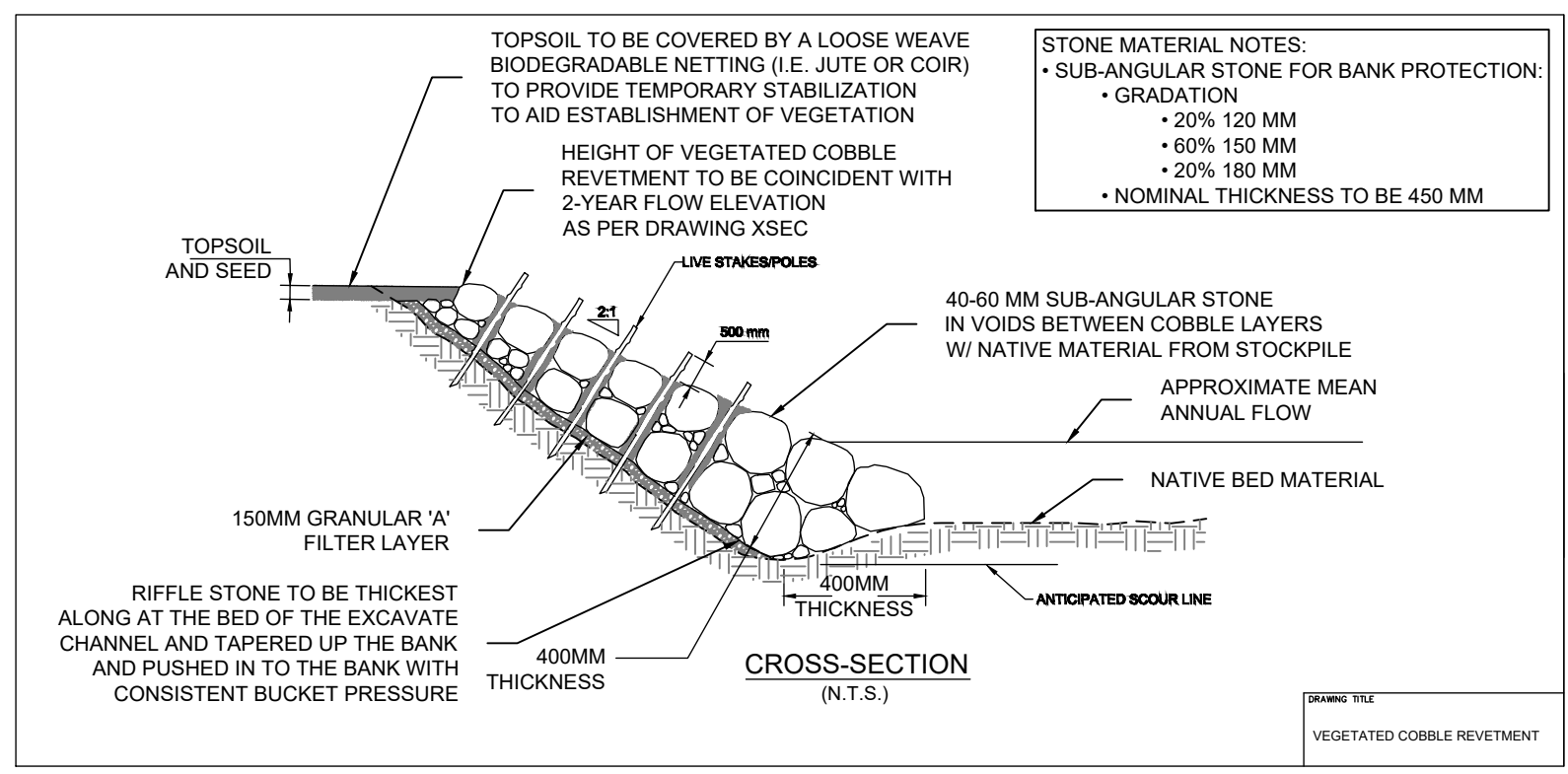
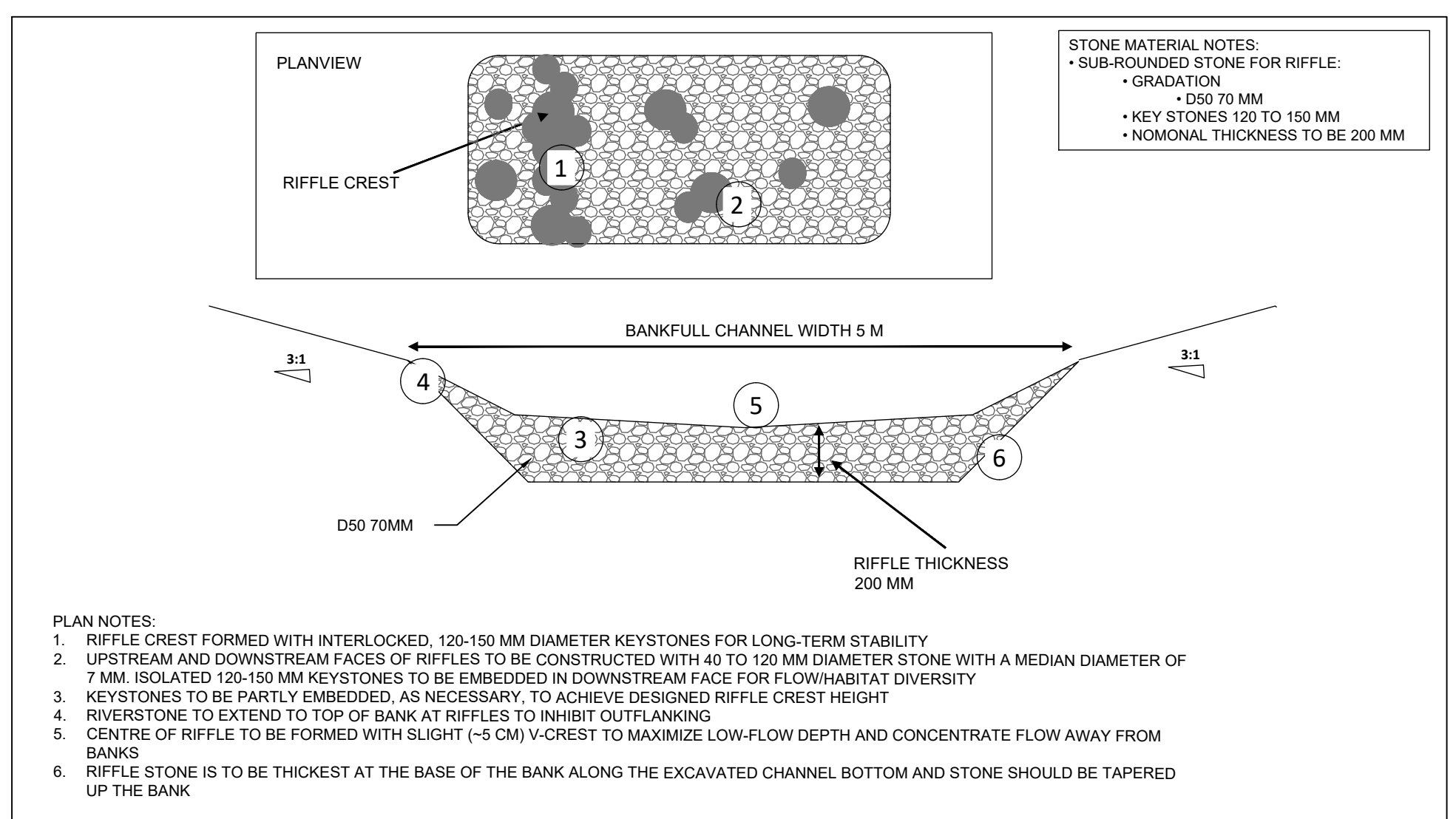

- VEGETATED COBBLE REVETMENT NOTES:**
- SUB-ANGULAR COBBLE REVETMENT TO BE VEGETATED WITH LIVE STAKING AND POLE PLANTING
  - LIVE CUTTINGS SHALL BE INSTALLED DURING COBBLE PLACEMENT TO ENSURE GOOD CONTACT WITH GROUND AND SOIL
  - USE PLANTINGS BAR TO PRE-INSTALL HOLE FOR LIVE STAKES INSERTED THROUGH VOIDS BETWEEN COBBLES
  - THE COBBLE REVETMENT SHALL BE CONSTRUCTED WITH WELL GRADED STONES DISTRIBUTED EVENLY THROUGHOUT THE MASS - STONES SHALL BE PLACED IN LIFTS
  - STONES SHALL BE HARD, DURABLE, AND RESISTANT TO THE WEATHERING AND WATER ACTION, AND MEET SPECIFIED GRADATION
  - TOE STONES TO BE FOUNDED BELOW THE CHANNEL BED TO MITIGATE AGAINST ANTICIPATED SCOUR
  - COBBLE REVETMENT VOIDS SHALL BE FILLED WITH GRAVEL AND SOIL MIX (FROM STOCKPILE)
  - A FILTER LAYER OF GRANULAR 'A' SHALL BE PLACED UNDER THE COBBLE REVETMENT TO PREVENT THE WASHOUT (PIPING) OF FINES THROUGH THE REVETMENT
  - LENGTH OF THE CUTTINGS SHALL DEPEND ON THE DEPTH THROUGH THE RIP RAP AND FILTER LAYER. LIVE WILLOW STAKES AND POLES CAN BE INCLUDED WITH 25-50mm DIAMETER AND LONG ENOUGH TO REACH BEYOND THE RIP RAP AND FILTER LAYER AND IN THE GROUND
  - EACH LAYER OF THE COBBLE REVETMENT TO BE CAREFULLY PLACED AND COMPRESSED INTO THE BANK TO MAXIMIZE INTERLOCKING STONE
  - LIVE CUTTINGS SHALL BE INSERTED IN THE RIPRAP DURING CONSTRUCTION SO THAT THE BUTT ENDS ARE IMBEDDED IN THE SOIL BEHIND THE COVER TO A DEPTH OF 0.3 - 0.5 m
  - ROOTS SHALL BE FULLY BURIED IN THE SOIL MATRIX
  - THE BRANCH TIPS SHOULD PROTRUDE FOR APPROXIMATELY 0.5M FROM THE STONE LAYER
  - PLACE NATIVE MATERIAL OVERTOP AND WITHIN VOIDS AND AROUND LIVE STAKES
  - SPREAD SEED MIX OVER FINISHED SLOPE AND PLACE EROSION CONTROL BLANKET (ECB) OVERTOP FINISHED SLOPE AND PINNED IN PLACE (NO METAL OR PLASTIC). ECB TO BE 100% COCONUT FIBRE COIR MAT, FULLY BIODEGRADABLE)

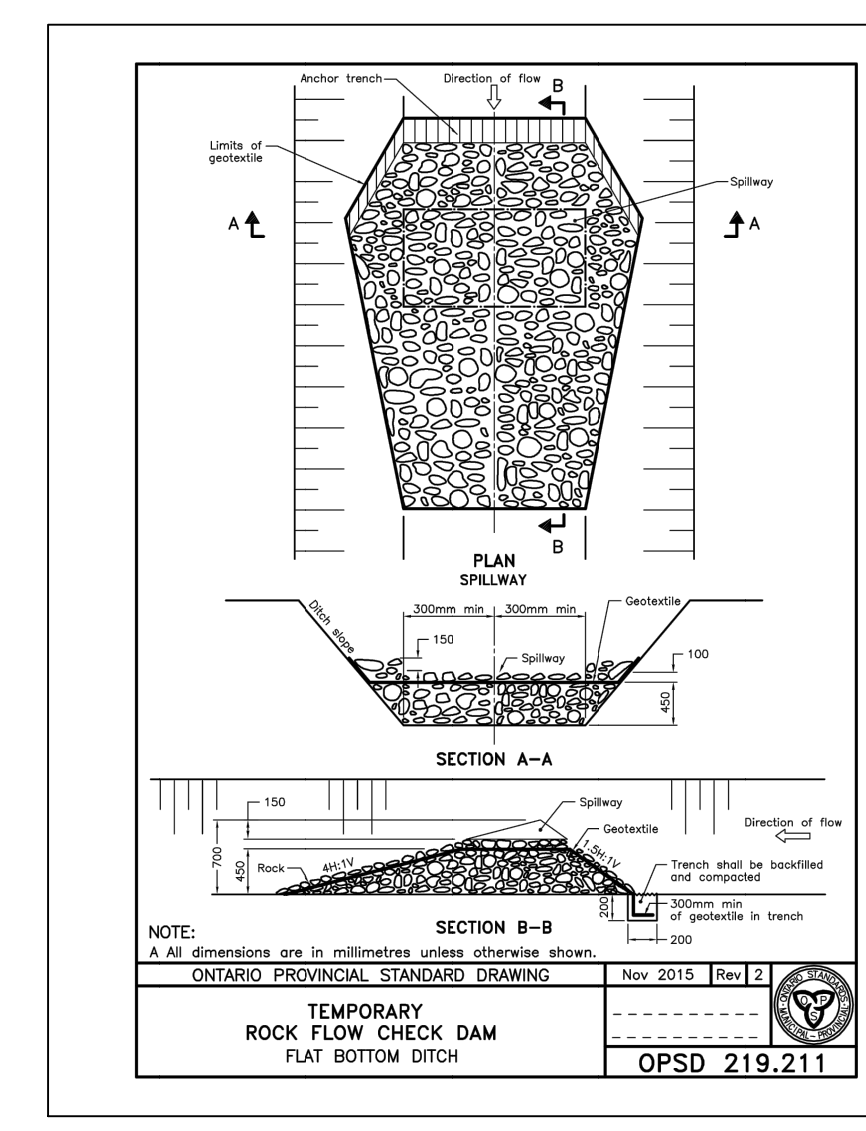

**UTILITY NOTES:**  
THE POSITION OF POLE LINES, CONDUITS, WATERMANS, SEWERS AND OTHER UNDERGROUND AND OVERGROUND UTILITIES AND STRUCTURES IS NOT NECESSARILY SHOWN ON THE CONTRACT DRAWING, AND WHERE SHOWN, THE ACCURACY OF THE POSITION OF SUCH UTILITIES AND STRUCTURES IS NOT GUARANTEED BEFORE STARTING WORK. THE CONTRACTOR SHALL INFORM 'HANDS' OF THE EXACT LOCATION OF ALL SUCH UTILITIES AND STRUCTURES, AND SHALL ASSUME ALL LIABILITY FOR DAMAGE.

**BENCHMARK:**  
ELEVATIONS ARE REFERRED TO THE CITY OF BRAMPTON BENCHMARK No. 042020221, BEING A BRASS CAP IN CONCRETE APPROX. 21 m SOUTH OF CENTRELINE OF HARBORVIEW ROAD AND 11 m EAST OF CENTRELINE OF REGIONAL ROAD 50, IN FRONT OF GAS STATION/COFFEE SHOP, HAVING AN ELEVATION OF 220.967 m.

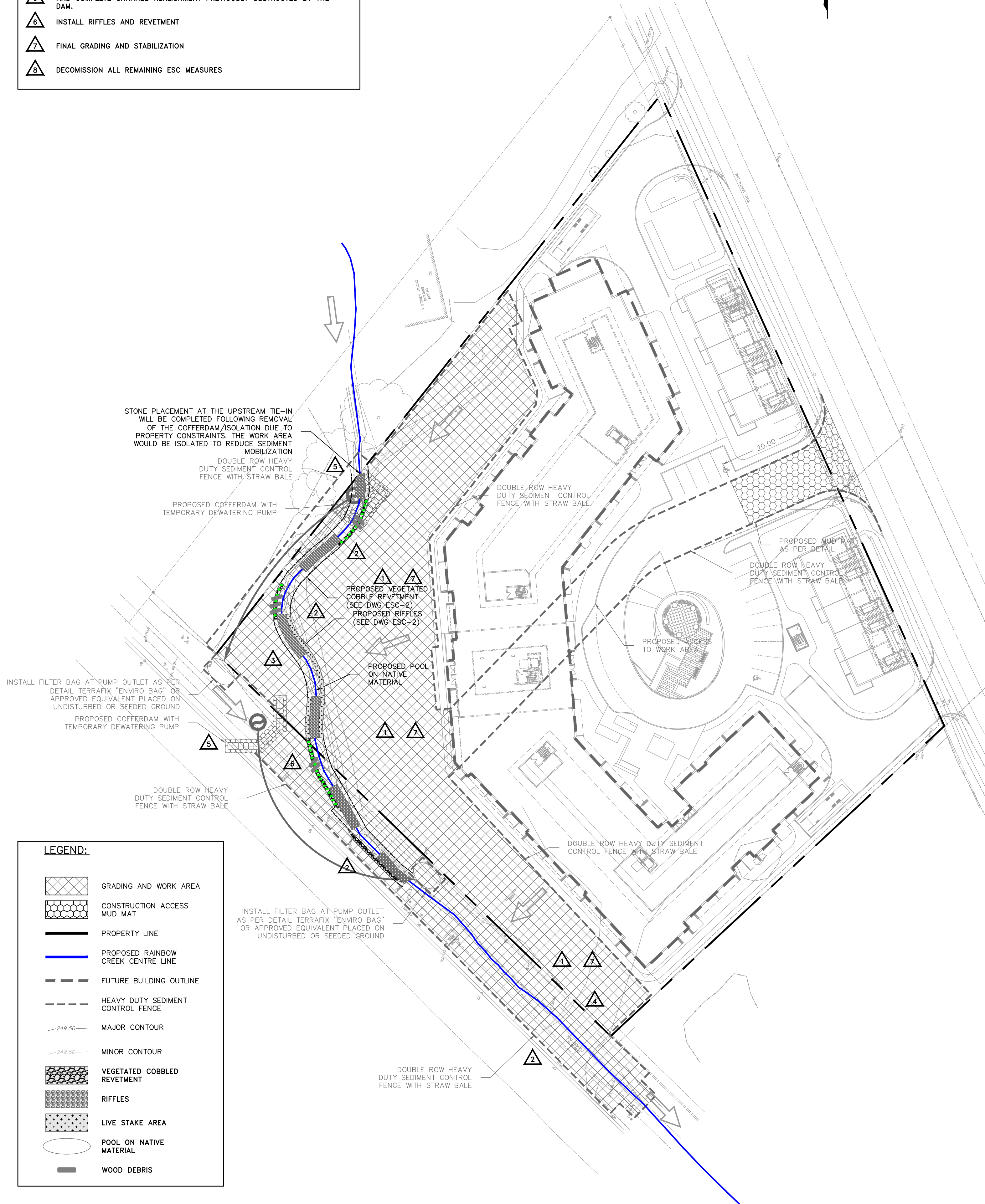

- LEGEND:**
- GRADING AND WORK AREA
  - CONSTRUCTION ACCESS MUD MAT
  - PROPERTY LINE
  - PROPOSED RAINBOW CREEK CENTRE LINE
  - FUTURE BUILDING OUTLINE
  - HEAVY DUTY SEDIMENT CONTROL FENCE
  - MAJOR CONTOUR
  - MINOR CONTOUR
  - VEGETATED COBBLED REVETMENT
  - RIFFLES
  - LIVE STAKE AREA
  - POOL ON NATIVE MATERIAL
  - WOOD DEBRIS

PROJECT: <b>MULTIPLE RESIDENTIAL CONDO DEVELOPMENT</b>			
12148 ALBION VAUGHAN ROAD, TOWN OF CALEDON			
CONSULTANT: <b>MASONGSONG ASSOCIATES</b>		380 KENNEDY ROAD SUITE 201 SCARBOROUGH, ONTARIO M1T 3K6 T: 416-291-8822 www.msa.ca	
CONSULTANT: <b>Palmer™</b>		CONSULTANT: <b>Conservation for The Living City</b>	
CONSULTANT: <b>Conservation for The Living City</b>		5 Shoreham Drive Downsview Ontario M3H 1S4 (416) 661-6600	
TITLE: <b>PHASE 2: EARTHWORKS AND CHANNEL RE-ALIGNMENT</b>			
DESIGN	W.A.	CHECKED	D.H.
SCALE	1:500		PLAN No. <b>ESC-2</b>
DATE	JANUARY 2021		