

TOWN OF CALEDON
PLANNING
RECEIVED
March 28, 2024

QUADREAL PROPERTY GROUP & TRIBAL PARTNERS CANADA INC.

12668 & 12862 DIXIE ROAD
CALEDON, ONTARIO CANADA



WARE MALCOMB
ARCHITECTURE
PLANNING
INTERIORS
CIVIL ENGINEERING
BRANDING
BUILDING MEASUREMENT
6220 Highway 7, Suite 300
Vaughan, Ontario, L4H 0R1, Canada
P 905.850.4696



QUADREAL PROPERTY GROUP & TRIBAL PARTNERS CANADA INC.
12668 & 12862 DIXIE ROAD
CALEDON, ONTARIO CANADA

VICINITY MAP	OWNER	OWNER'S CONSULTANTS	SHEET INDEX
--------------	-------	---------------------	-------------

TOTAL SHEETS
18

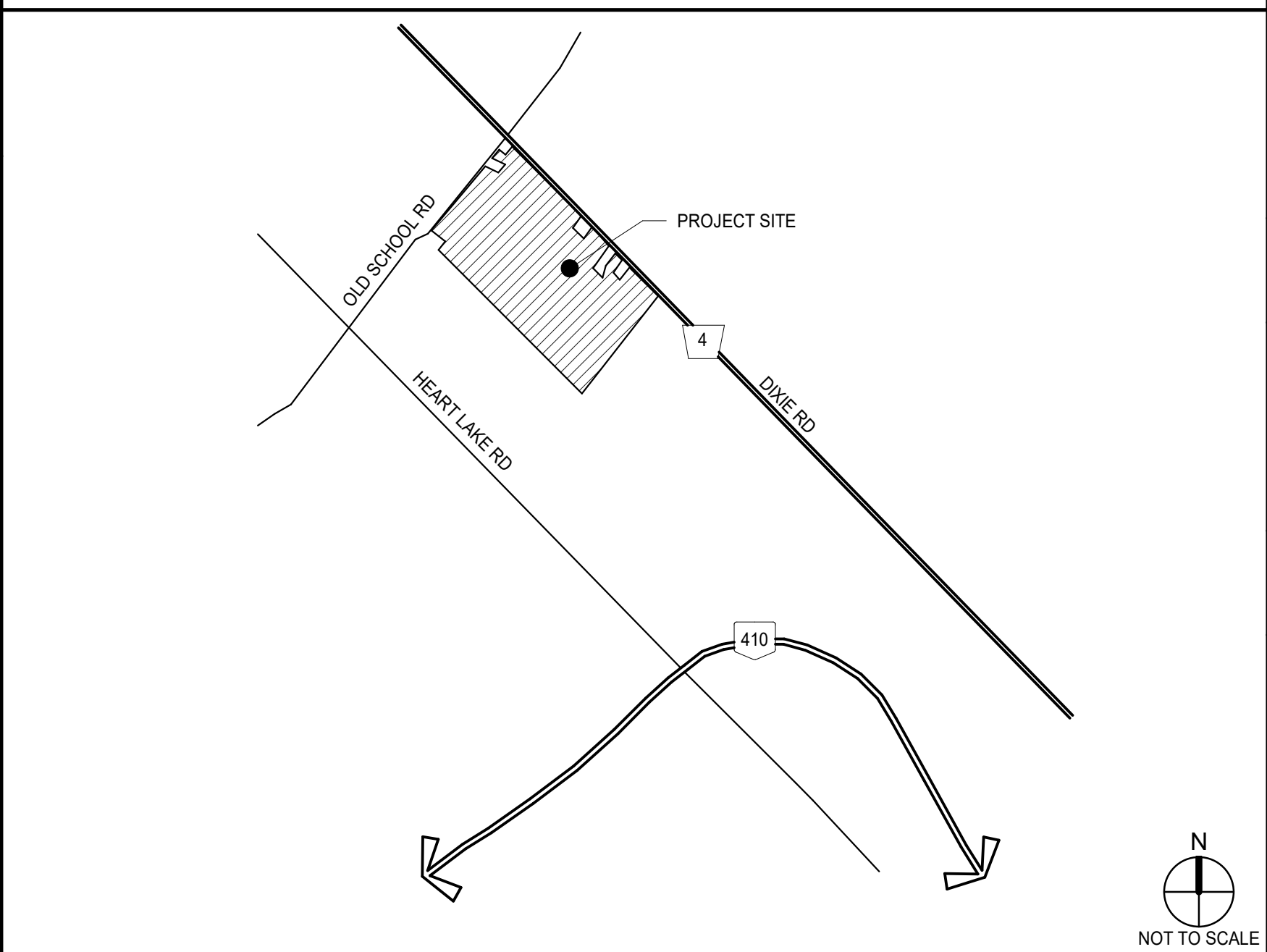

QUADREAL PROPERTY GROUP
199 BAY ST SUITE 4900
TORONTO, ONTARIO M5L 1G2
CONTACT: JOHN MAROTTA
PH: (416) 673 7401 / M: (416) 712 7686
EMAIL: john.marotta@quadreal.com

CIVIL ENGINEER
WSP CANADA INC.
25 YORK STREET, SUITE 700
TORONTO, ONTARIO M5J 2V5
PRIMARY CONTACT: ALEX WILLIAMS
PH: (647) 730-7156
EMAIL:

GENERAL CONTRACTOR

TRANSPORTATION CONSULTANT
BA CONSULTING GROUP LTD.
95 ST. CLAIR AVENUE WEST,
SUITE 1000 | TORONTO
PRIMARY CONTACT: THOMAS WOODHALL
PH: (416) 961-7110
EMAIL: woodhall@bagroup.com

ARCHITECT
WARE MALCOMB
6220 HIGHWAY 7, SUITE 300
VAUGHAN, ONTARIO, L4H 0R1,
CANADA
P.905.850.4696
PRIMARY CONTACT: AMANDA SANABRIA
PH: (905) 760-1221 x2142
EMAIL: asanabria@waremalcomb.com

PLANNER
ARMSTRONG CONSULTING
1600 STEELES AVENUE WEST
SUITE 318
VAUGHAN, ONTARIO L4K 4M2
PRIMARY CONTACT: SCOTT BORDEN
PH: (416) 444-3300 X 3007
EMAIL: scott@armstrongplan.ca

ARCHITECTURAL

G010	TITLE SHEET
G020	MATRIX SCHEDULE
A100	OVERALL SITE PLAN
A120	BUILDING 1 - FLOOR PLAN
A121	BUILDING 2 - FLOOR PLAN
A122	BUILDING 3 - FLOOR PLAN
A123	BUILDING 3 - FLOOR PLAN
A124	BUILDING 3 - FLOOR PLAN
A125	BUILDING 3 - FLOOR PLAN
A126	BUILDING 3 - FLOOR PLAN
A127	BUILDING 3 - FLOOR PLAN
A190	BUILDING 1 - ROOF PLAN
A191	BUILDING 2 - ROOF PLAN
A210	BUILDING 1- EXTERIOR ELEVATIONS
A211	BUILDING 2 - EXTERIOR ELEVATIONS
A212	BUILDING 2 - EXTERIOR ELEVATIONS
A310	BUILDING 1 - BUILDING SECTIONS
A311	BUILDING 2 - BUILDING SECTIONS
ARCHITECTURAL SHEET COUNT: 18	

TITLE SHEET	
DATE	REMARKS
1	12-12-2023
ISSUED FOR OPAZBA	

PA/PM:	A. SANABRIA
DRAWN BY.:	O.S.
JOB NO.:	TOR22-0054-01

SHEET
G010