

PLANTING LIST:

DECIDUOUS TREES

SYMBOL	ABBR.	BOTANICAL NAME	COMMON NAME	CONDITION	REMARKS	HEIGHT	CALIPER	QUANTITY
	CC	CERCIS CANADENSIS	Eastern Redbud				60 mm	11
	GTS	GLEDTISIA TRICANTHOS 'SUNBURST'	Sunburst Honeylocust	WB			60 mm	4
	AF	ACER X FREEMANIR ARMSTRONG	Armstrong Maple	WB			60 mm	2

CONIFERS

SYMBOL	ABBR.	BOTANICAL NAME	COMMON NAME	CONDITION	REMARKS	HEIGHT	CALIPER	QUANTITY
	TO	THUJA OCCIDENTALIS	Eastern White Cedar (ARBORVITAE)				175 mm	6

SHRUBS

	CD	COTONEASTER DAMMERI	Bearberry Cotoneaster			3 gal	Full and bushy	0.6 m	248
	SBA	SPIREA BUMALDA 'ANTHONY WATERER'	Anthony Waterer Spirea			3 gal	Full and bushy	0.6 m	24
	JMO	JUNIPERUS MEDIA 'OLD GOLD JUNIPER'						60 cm	21
	BMG	BUXUS MIC. 'GREEN MOUND BOXWOOD'						60 cm	26
	TMH	TAXUS MEDIA 'HICK'S YEW'						60 cm	8
	JCG	JUNIPERUS CHINENSIS 'GOLD COAST JUNIPER'						80 cm	15

Contractor must check and verify all dimensions and be responsible for same, reporting any discrepancies to the Engineer before commencing work.
Prints shall not be used for construction until signed 'Approved For Construction' by the Engineer.
Prints are not to be scaled.
All drawings, prints and specifications are the property of the Engineer and shall be returned to him on completion of the work.
All work shall be performed in accordance with the latest edition of the ONTARIO BUILDING CODE, NATIONAL BUILDING CODE and regulatory regulations of the TOWN OF CALEDON Building Department.
These notes are to be read in conjunction with all drawings and specifications.

The Contractor shall check all dimensions and other data from the job and report any discrepancies to the Architects before proceeding.

No.	Date:	Revision:	D'wn.	Ch'd.
1.	AUG23-21	ISSUED FOR SPA	N.R.	J.R.

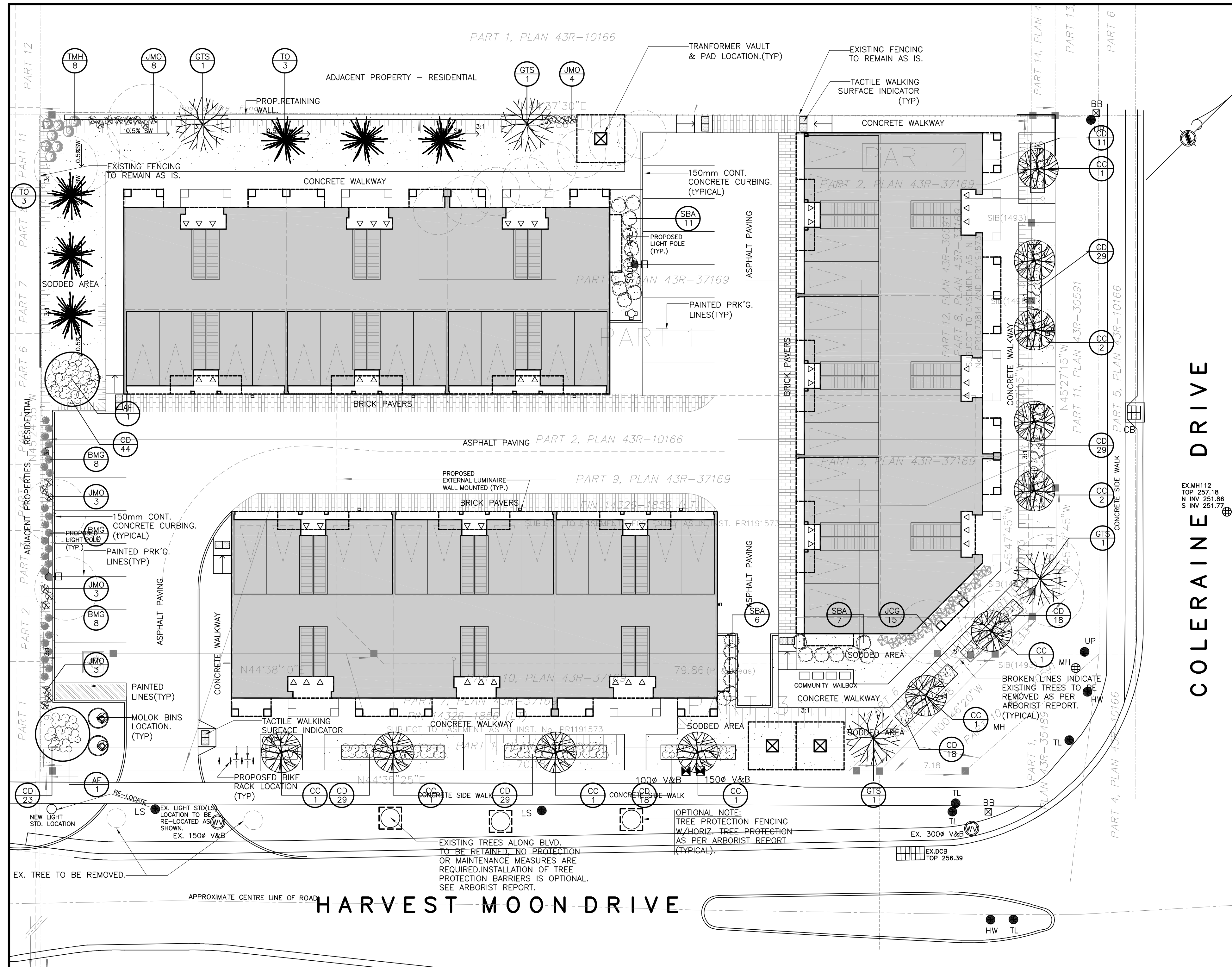

GENERAL NOTES

- NOTE 1: THE STREET DEPICTED ON THIS PLAN INDICATE THE SPECIES AND THE GENERAL LOCATION OF THE TREES. ONCE THE DRIVEWAYS AND ALL THE UTILITIES AND LIGHT STANDARDS HAVE BEEN INSTALLED, THE EXACT LOCATION OF STREET TREES WILL BE DETERMINED BY THE LANDSCAPE ARCHITECT AND APPROVED BY THE TOWN PRIOR TO PLANTING.
- NOTE 2: CLEARANCES TO UTILITY FURNITURE AND INTERSECTIONS FOR STREET TREES (WHEN TREES ARE 1.5 m FROM THE CURB):
 *2 m FROM WATER HYDRANTS
 *2 m FROM DRIVEWAYS
 *2 m FROM COMMUNITY MAILBOXES
 3 m FROM HYDRO TRANSFORMERS
 5 m FROM STREET LIGHTS
 15 m MINIMUM FROM STREET LINE (STREET INTERSECTIONS AS MEASURED FROM THE BACK OF THE CURB) AND BEHIND DAYLIGHT TRIANGLE AS PER GEOMETRIC DESIGN STANDARDS FOR ONTARIO HIGHWAYS.
 18 m FROM FACE OF WALL WARNING AND REGULATORY SIGNS.
- WHEN THE MINIMUM DISTANCES NOTED ABOVE ARE NOT ACHIEVABLE, TREES MAY BE PLANTED 0.5m FROM THE PROPERTY LINE AS AN ALTERNATE LOCATION (BEHIND THE SIDEWALK), ADJACENT TO FENCES, OR JUST INSIDE THE STREET LINE, ON PRIVATE PROPERTY, AS IN THE CASE OF A CUL-DE-SAC. *IF THE TREE IS PLANTED IN AN ALTERNATE LOCATION, THE DISTANCES MARKED WITH AN ASTERISK MUST STILL BE MAINTAINED.
- NOTE 3: THE TREE PITS AND PLANTING BEDS FOR ALL THE TREES AND SHRUBS LOCATED WITHIN 1 METRE OR LESS OF UNDERGROUND UTILITIES ARE TO BE HAND DUG.
- NOTE 4: ALL PLANT MATERIAL IS TO BE INSPECTED AND APPROVED BY THE LANDSCAPE ARCHITECT PRIOR TO SHIPMENT TO THE SITE. THIS DOES NOT LIMIT THE RIGHT OF THE LANDSCAPE ARCHITECT OR THE MUNICIPALITY TO REJECT THE MATERIAL DUE TO POOR QUALITY, DAMAGE DURING THE INSTALLATION, OR POOR PERFORMANCE DURING THE WARRANTY PERIOD.
- NOTE 5: ALL PLANTING AND HARD LANDSCAPE FEATURES ARE TO BE LAID OUT ON SITE BY THE LANDSCAPE ARCHITECT TO THE SATISFACTION OF THE TOWNSHIP OF KING PRIOR TO INSTALLATION. ANY DEVIATIONS FROM THE APPROVED LANDSCAPE PLANS REQUIRE PRIOR TOWN APPROVAL.
- NOTE 6: UPON COMPLETION OF LANDSCAPING, THE LANDSCAPE ARCHITECT SHALL SUBMIT A CERTIFICATE OF COMPLIANCE TO THE PLANNING DEPARTMENT CERTIFYING THAT ALL LANDSCAPE WORKS HAVE BEEN COMPLETED IN ACCORDANCE WITH THE APPROVED PLANS, AND AN INSPECTION CHART INDICATING PLANT SPECIES, QUANTITY, LOCATION, PLANTING DATE(S), AND ALL OTHER RELEVANT INFORMATION AS SPECIFIED BY THE TOWN UPON RECEIPT OF THE CERTIFICATE OF COMPLIANCE. THE PLANNING DEPARTMENT SHALL CONDUCT A PRELIMINARY INSPECTION OF THE SITE AND, PROVIDED THAT THE WORKS ARE IN SATISFACTORY CONDITION, SHALL GRANT PRELIMINARY ACCEPTANCE OF THE LANDSCAPING.
- NOTE 7: ALL STREETScape LANDSCAPING IS SUBJECT TO A TWO(2) YEAR WARRANTY PERIOD. COMMENCING FROM THE DATE THAT PRELIMINARY ACCEPTANCE IS GRANTED BY THE MUNICIPALITY. AFTER THE FIRST AND SECOND YEAR, THE LANDSCAPE ARCHITECT WILL CONDUCT A PERFORMANCE INSPECTION AND MAKE RECOMMENDATIONS REGARDING REPLACEMENTS AND/OR WORKS TO ACHIEVE THE INTENT OF THE APPROVED LANDSCAPE PLAN ALL WARRANTY REPLACEMENTS ARE TO BE RECORDED ON THE INSPECTION CHART. AT THE END OF THE WARRANTY PERIOD, THE MUNICIPALITY WILL CONDUCT A FINAL INSPECTION AND, PROVIDED THE WORKS ARE STILL IN SATISFACTORY CONDITION, SHALL GRANT FINAL ACCEPTANCE. FOR THE WORKS REPLACED OR REPAIRED DURING THE WARRANTY PERIOD, THE WARRANTY PERIOD FOR SUCH WORKS SHALL BE EXTENDED FOR AN ADDITIONAL TWO YEAR PERIOD, AND SHALL NOT BE GRANTED FINAL ACCEPTANCE UNTIL EXPIRY OF THE EXTENDED WARRANTY PERIOD, OR AS OTHERWISE DETERMINED BY THE MUNICIPAL PLANNING DEPARTMENT.

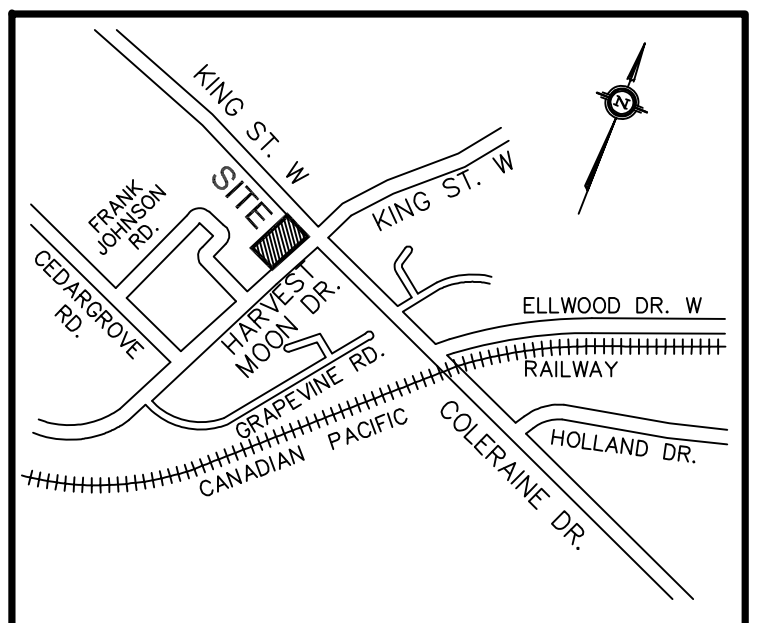

KEY PLAN

SCALE: N.T.S.

APPLICANT:
HUMPHRIES PLANNING GROUP INC.
190 PIPPIN ROAD, SUITE A
VAUGHAN, ON L4K 4X9
TEL: 905-264-7678 EXT. 244
EMAIL: rhumphries@humphriesplanning.com

OWNER:
HARVESTSTONE CENTRE INC.
3 BROWNING COURT
BOLTON, ON L7E 5S6
TEL: 905-857-3266
EMAIL: vince@boltonrailings.com

ARCHITECTS / ENGINEERS:
SOCIA PROFESSIONAL ENGINEERS INC
10376 YONGE STREET, SUITE 307
RICHMOND HILL, ON L4C 3B8
TEL: 905 237 5410
FAX: 905 237 5413
CEL: 416 704 3868
E-MAIL: hmo@socioeng.ca



JOHN A. RUSSO LANDSCAPE ARCHITECT

11 CURTIS COURT
MAPLE, ONT.
L6A-1Y4
TEL/FAX: (905) 832-9123

Project:
PROPOSED:
STACKED TOWNHOUSE
DEVELOPMENT
13656 EMIL KOLB PARKWAY
CALEDON, ONTARIO.
SPA 2021-0077

Sheet title:
LANDSCAPE PLAN
Job. no.
20-007
Scale: AS NOTED Date: DEC 2020 D'wg. no.
Drawn: N.R. Checked: H.M. LI of X