

**SUBMISSION
DRAWING**
NOT TO BE USED FOR CONSTRUCTION

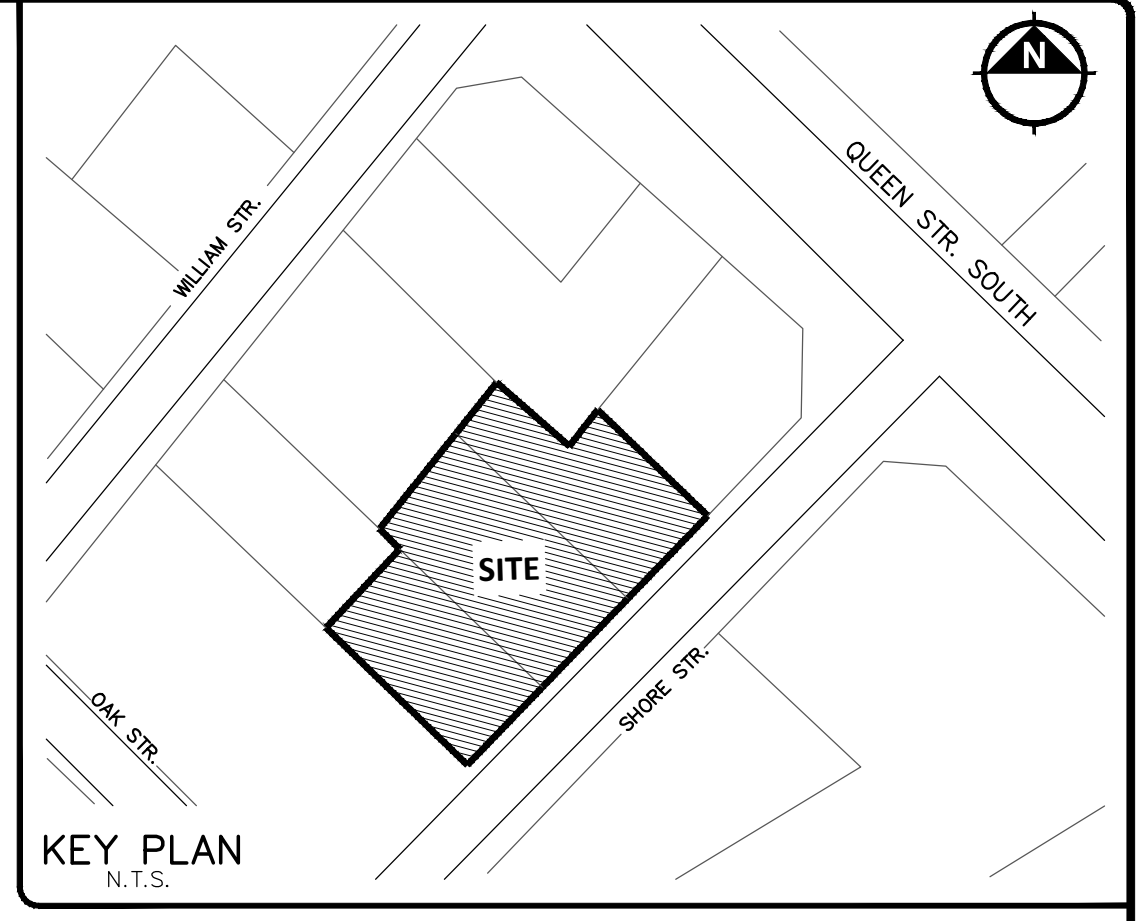

OAK STREET

REGIONAL ROAD #50
HIGHWAY 50

SHORE STREET

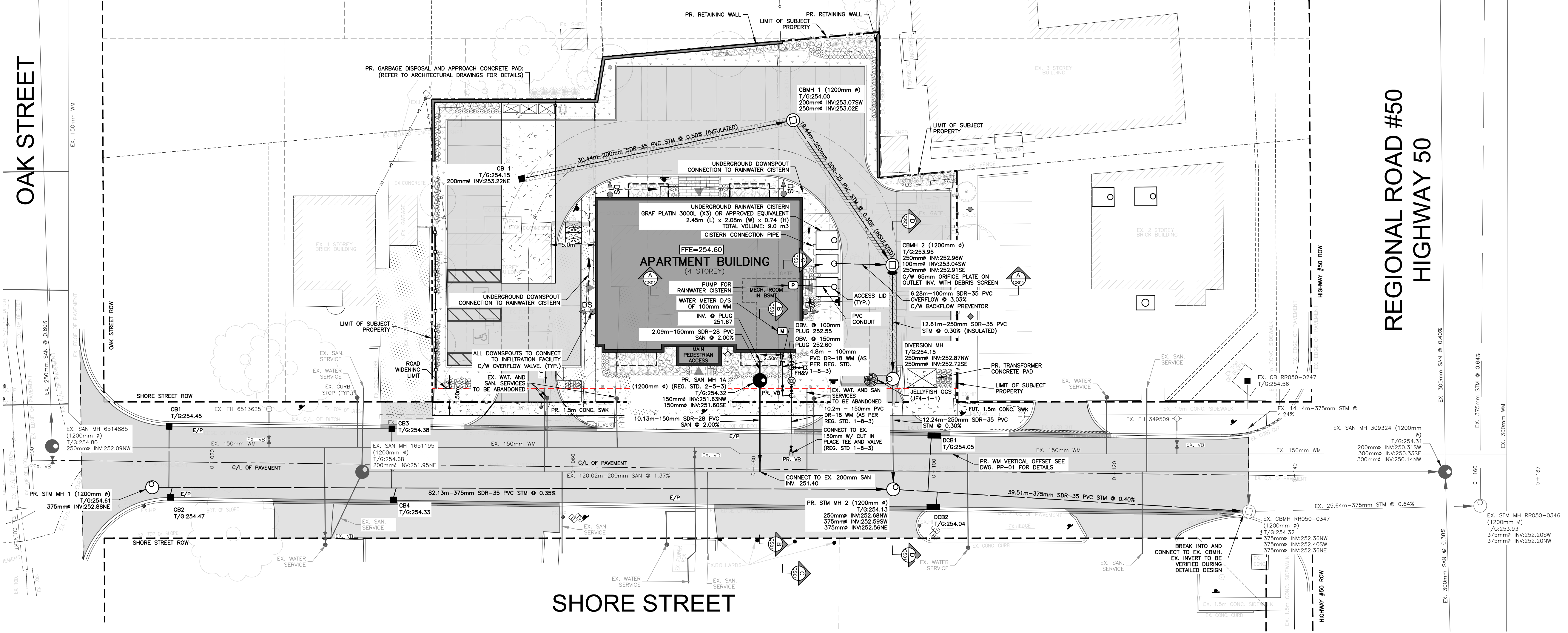

- LIMIT OF SUBJECT PROPERTY
- ⊕ VALVE AND BOX
- ⊕ HYDRANT
- CB □ CATCH BASIN
- DCB □ DOUBLE INLET CATCHBASIN
- ⊕ SANITARY MANHOLE
- ⊕ STORM MANHOLE
- ⊕ CATCH BASIN MANHOLE
- ⊕ DETECTOR CHECK VALVE IN CHAMBER
- ⊕ CONCRETE WALKWAY
- ⊕ LANDSCAPED AREAS
- ⊕ DS DOWNSPOUT (C/W OVERFLOW VALVE)
- ⊕ TRAFFIC SIGN (REFER TO ARCHITECTURAL DWG FOR DETAILS)
- WATER MAIN
- SANITARY SEWER
- STORM SEWER
- MAJOR OVERLAND FLOW

SUBMISSION HISTORY		
No.	ISSUED FOR	DATE
1	ISSUED FOR FIRST SUBMISSION	24/09/24

REVISIONS			
No.	DESCRIPTION	BY	DATE

BENCHMARK NOTE:
ELEVATIONS SHOWN ARE RELATED TO GEODETIC DATUM AND ARE DERIVED FROM TOWN OF CALEDON BENCH MARK NO. 75857 HAVING A PUBLISHED ELEVATION OF 251.92m.

SURVEY COMPLETED BY:
GUIDO PAPA SURVEYING
9135 KELLE STREET, UNIT B7
VAUGHAN, ONTARIO
L4K 5J4

GUIDO PAPA REF. NO. 23-18-550-00
SURVEY COMPLETED ON:
AUGUST 11, 2023

CONSULTANT

MUNICIPAL APPROVAL

APPROVED AS TO FORM IN RELIANCE UPON THE PROFESSIONAL SKILL AND ABILITY OF URBANWORKS ENGINEERING CORP. AS TO DESIGN AND SPECIFICATION.

DIRECTOR OF DEVELOPMENT ENGINEERING
DAN TERZIEVSKI

DATE



**MULTI-UNIT RESIDENTIAL DEVELOPMENT
SHORE STREET URBANIZATION**
15,21,27 SHORE STREET, CALEDON



SCALE
0 2.5 5 7.5 10 12.5 15 17.5 20 22.5 25m

SITE SERVICING PLAN

TOWN FILE: PRE-2023-0116 PRE-2023-0274	PROJECT No. 24-0002CA
REGION FILE:	DWG. No. SS-01
DATE: JUN 2024	DESIGNED BY: DV
SCALE: 1:250	DRAWN BY: DV
	CHECKED BY: TD

**TOWN OF CALEDON
PLANNING
RECEIVED**
October 8, 2024