

ROOF LEADERS FROM BLOCK 2 AND BLOCK 3 TO DISCHARGE TO THE WOODLOT (BLOCK 162A)

ALL WATER SERVICES SHALL BE MINIMUM 25mm DIA NOMINAL COPPER PIPE SIZE OR 25mm DIA POLYETHYLENE PIPE.

ALL SANITARY SERVICE LATERALS SHALL BE MINIMUM 125mm DIAMETER PVC SDR 28.

ALL HYDRANT LEADS TO BE 150mm DIAMETER PVC DR-18.

SINGLE CATCHBASINS SHALL BE IN ACCORDANCE WITH OPSD 705.010 AND DOUBLE CATCHBASINS AS PER OPSD 705.020.

INTERNAL STORM SEWER IS TO BE LOCATED A MINIMUM OF 1.0m BELOW BFE FOR THE PROPOSED CONNECTIONS

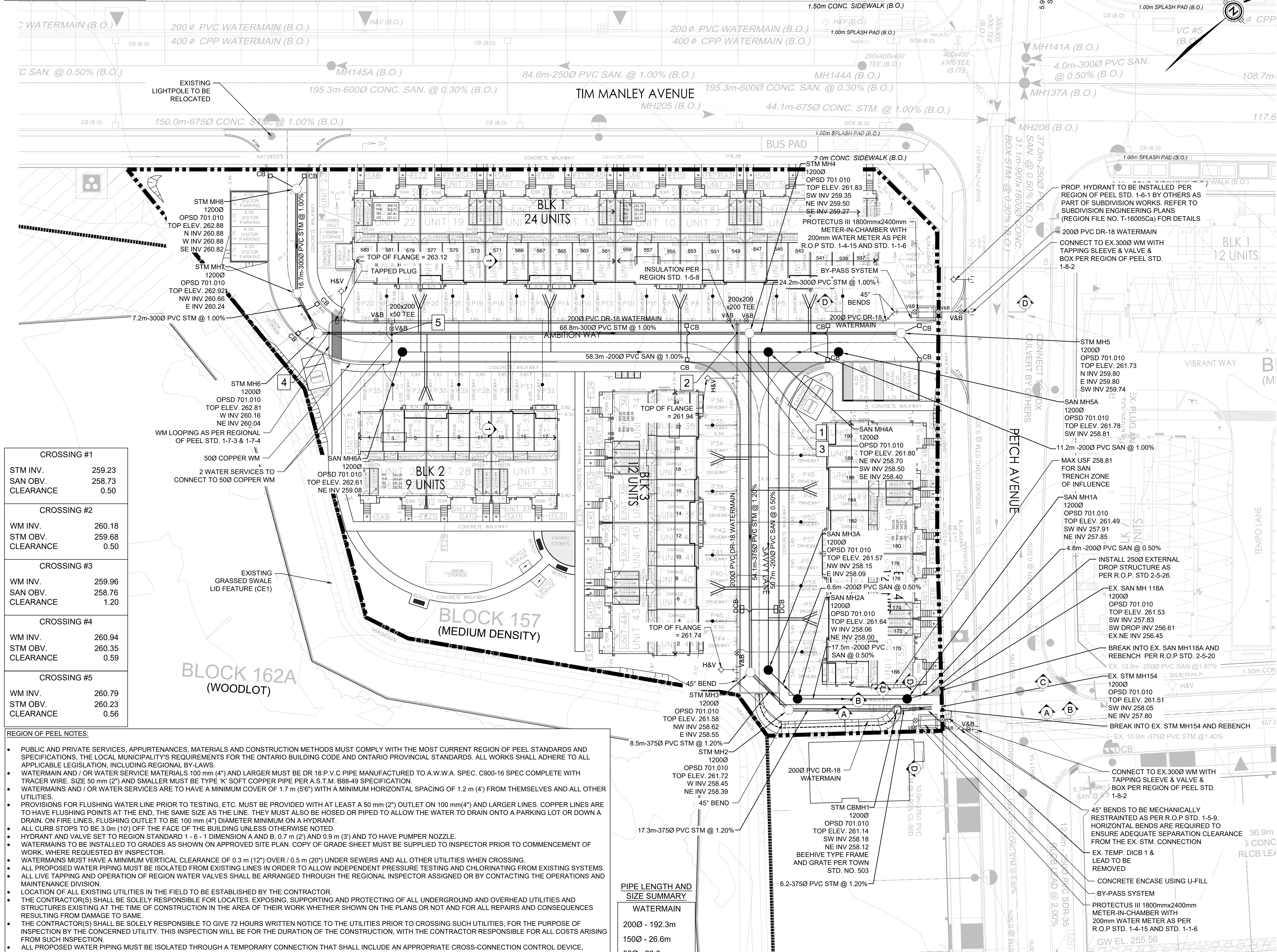

CROSSING #1	STM INV.	SAN OBV.	CLEARANCE
	259.23	258.73	0.50
CROSSING #2	WM INV.	STM OBV.	CLEARANCE
	260.18	259.68	0.50
CROSSING #3	WM INV.	SAN OBV.	CLEARANCE
	259.96	258.76	1.20
CROSSING #4	WM INV.	STM OBV.	CLEARANCE
	260.94	260.35	0.59
CROSSING #5	WM INV.	STM OBV.	CLEARANCE
	260.79	260.23	0.56

REGION OF PEEL NOTES:

- PUBLIC AND PRIVATE SERVICES, APPURTENANCES, MATERIALS AND CONSTRUCTION METHODS MUST COMPLY WITH THE MOST CURRENT REGION OF PEEL STANDARDS AND SPECIFICATIONS, THE LOCAL MUNICIPALITY'S REQUIREMENTS FOR THE ONTARIO BUILDING CODE AND ONTARIO PROVINCIAL STANDARDS. ALL WORKS SHALL ADHERE TO ALL APPLICABLE LEGISLATION, INCLUDING REGIONAL BY-LAWS.
- WATERMAIN AND / OR WATER SERVICE MATERIALS 100 mm (4") AND LARGER MUST BE DR 18 P.V.C PIPE MANUFACTURED TO A.W.W.A. SPEC. C900-16 SPEC COMPLETE WITH TRACER WIRE. SIZE 50 mm (2") AND SMALLER MUST BE TYPE "K" SOFT COPPER PIPE PER A.S.T.M. B88-49 SPECIFICATION.
- WATERMANS AND / OR WATER SERVICES ARE TO HAVE A MINIMUM COVER OF 1.7 m (5'6") WITH A MINIMUM HORIZONTAL SPACING OF 1.2 m (4') FROM THEMSELVES AND ALL OTHER UTILITIES.
- PROVISIONS FOR FLUSHING WATER LINE PRIOR TO TESTING, ETC. MUST BE PROVIDED WITH AT LEAST A 50 mm (2") OUTLET ON 100 mm (4") AND LARGER LINES. COPPER LINES ARE TO HAVE FLUSHING POINTS AT THE END, THE SAME SIZE AS THE LINE. THEY MUST ALSO BE HOSED OR PIPED TO ALLOW THE WATER TO DRAIN ONTO A PARKING LOT OR DOWN A DRAIN. ON FIRE LINES, FLUSHING OUTLET TO BE 100 mm (4") DIAMETER MINIMUM ON A HYDRANT.
- ALL CURB STOPS TO BE 3.0m (10') OFF THE FACE OF THE BUILDING UNLESS OTHERWISE NOTED.
- HYDRANT AND VALVE SET TO REGION STANDARD 1 - 6 - 1 DIMENSION A AND B, 0.7 m (2') AND 0.9 m (3') AND TO HAVE PUMPER NOZZLE.
- WATERMANS TO BE INSTALLED TO GRADES AS SHOWN ON APPROVED SITE PLAN. COPY OF GRADE SHEET MUST BE SUPPLIED TO INSPECTOR PRIOR TO COMMENCEMENT OF WORK, WHERE REQUESTED BY INSPECTOR.
- WATERMANS MUST HAVE A MINIMUM VERTICAL CLEARANCE OF 0.3 m (12") OVER 1.0 m (20") UNDER SEWERS AND ALL OTHER UTILITIES WHEN CROSSING.
- ALL PROPOSED WATER PIPING MUST BE ISOLATED FROM EXISTING LINES IN ORDER TO ALLOW INDEPENDENT PRESSURE TESTING AND CHLORINATING FROM EXISTING SYSTEMS.
- ALL LIVE TAPPING AND OPERATION OF REGION WATER VALVES SHALL BE ARRANGED THROUGH THE REGIONAL INSPECTOR ASSIGNED OR BY CONTACTING THE OPERATIONS AND MAINTENANCE DIVISION.
- LOCATION OF ALL EXISTING UTILITIES IN THE FIELD TO BE ESTABLISHED BY THE CONTRACTOR.
- THE CONTRACTOR(S) SHALL BE SOLELY RESPONSIBLE FOR LOCATES, EXPOSING, SUPPORTING AND PROTECTING OF ALL UNDERGROUND AND OVERHEAD UTILITIES AND STRUCTURES EXISTING AT THE TIME OF CONSTRUCTION IN THE AREA OF THEIR WORK WHETHER SHOWN ON THE PLANS OR NOT AND FOR ALL REPAIRS AND CONSEQUENCES RESULTING FROM DAMAGE TO SAME.
- THE CONTRACTOR(S) SHALL BE SOLELY RESPONSIBLE TO GIVE 72 HOURS WRITTEN NOTICE TO THE UTILITIES PRIOR TO CROSSING SUCH UTILITIES, FOR THE PURPOSE OF INSPECTION BY THE CONCERNED UTILITY. THIS INSPECTION WILL BE FOR THE DURATION OF THE CONSTRUCTION, WITH THE CONTRACTOR RESPONSIBLE FOR ALL COSTS ARISING FROM SUCH INSPECTION.
- ALL PROPOSED WATER PIPING MUST BE ISOLATED THROUGH A TEMPORARY CONNECTION THAT SHALL INCLUDE AN APPROPRIATE CROSS-CONNECTION CONTROL DEVICE, CONSISTENT WITH THE DEGREE OF HAZARD, FOR BACKFLOW PREVENTION OF THE ACTIVE DISTRIBUTION SYSTEM, CONFORMING TO REGION OF PEEL STANDARDS 1-7-7 OR 1-7-8.
- ALL WATER METERS MUST BE INSTALLED IN HEATED AND ACCESSIBLE SPACE.

PIPE LENGTH AND SIZE SUMMARY

WATERMAIN
2000 - 192.3m
1500 - 26.6m
500 - 20.6m

KEY PLAN NTS

- LEGEND**
- STORM MANHOLE
 - SANITARY MANHOLE
 - CATCHBASIN
 - ◇ HYDRANT & VALVE
 - ⊕ VALVE AND BOX
 - ↑ WATER SERVICE
 - Y DOUBLE STORM & SANITARY SERVICES
 - SINGLE STORM & SANITARY SERVICES
 - DEPRESSED CURB
 - PROPERTY LIMIT
 - EX. STOP SIGN
 - EX. STREET SIGN
 - EX. HYDRO POLE WITH STREET LIGHT
 - EX. HYDRO ONE SWITCH GEAR
 - PROP. LINE PAINTING
 - ▽ DOWNSPOUTS
 - ◻ TRANSFORMER

BENCHMARK INFORMATION:
BEARINGS ARE UTM GRID, DERIVED FROM SPECIFIED CONTROL AND 01019840166, UTM ZONE 17 (NAD - 1983; CSRS.CENVE6 - 2010.0)

POINT ID	NORTHING	EASTING
SCP 01019840167	4840745.81	592953.24
SCP 01019840166	4841480.91	593517.99

No.	REVISIONS TO DRAWING	BY	DATE	APPR.
10.	CONDO PLAN OVERLAY	A.S.	12/16/24	J.V.
9.	ISSUED FOR SITE INSTRUCTION	W.Z.	10/31/23	A.D.R.
8.	ISSUED FOR SERVICING APPROVAL	W.Z.	10/16/23	A.D.R.
7.	ISSUED FOR CONSTRUCTION	W.Z.	09/06/23	A.D.R.
6.	4TH SPA SUBMISSION	W.Z.	08/16/23	A.D.R.
5.	ISSUED FOR TOWN SUBMISSION	W.Z.	08/10/23	A.D.R.
4.	3RD SPA SUBMISSION	W.Z.	07/07/23	A.D.R.
3.	ISSUED FOR ADDENDUM #1	W.Z.	05/12/23	A.D.R.

ALL PREVIOUS ISSUES OF THIS DRAWING ARE SUPERSEDED

CLIENT
ZANCOR HOMES

MUNICIPALITY
TOWN OF CALEDON

PROJECT TITLE
COMMON ELEMENT CONDOMINIUM CORPORATION
BLOCK 157 (ZANCOR)
531-562 TIM MANLEY AVE. (3RD FLOOR ONLY)
1-17 AMBITION WAY (GDD ONLY)
2-34 SAVVY LANE (EVEN ONLY)
168-180 FETCH AVENUE (EVEN ONLY)

SHEET TITLE
SITE SERVICING PLAN

CONSULTANT
wsp

100 Commerce Valley Dr. West, Thornhill, ON Canada L3T 0A1
1.905.882.1100 | 1.905.882.9955 | www.wsp.com

DESIGNED W.Z.	DRAWN 10/12 CAD	CHECKED A.D.R.
SCALE 1:300	DATE JUN 2024	DWG. NUMBER SS1
PROJECT NUMBER 211-00703		

REGION'S FILE NUMBER: C603204 TOWN SPA FILE NUMBER: SPA 22-51

FILENAME: X:\DWG\2024\00703\Block 157\Zancor\SiteServicing\Drawings\211-00703_SSP-1621-EP1.dwg
PLOTDATE: Dec 18, 2024, 2:18pm, CA5037125