

- CONSTRUCTION NOTES (REGION OF PEEL)**
- ALL MATERIALS AND CONSTRUCTION METHODS MUST CORRESPOND TO THE CURRENT PEEL PUBLIC WORKS STANDARDS AND SPECIFICATIONS.
 - WATERMAIN AND/OR WATER SERVICE MATERIALS 100mm (4") AND LARGER MUST BE A.W.W.A. C900; SIZE 50mm (2") AND SMALLER TO BE COPPER TYPE 'K' B88-48.
 - WATERMANS AND/OR WATER SERVICES ARE TO HAVE A MINIMUM COVER OF 1.7m (5'6") WITH A MINIMUM HORIZONTAL SPACING OF 1.2m (4') FROM THEMSELVES AND ALL OTHER UTILITIES.
 - PROVISIONS FOR FLUSHING WATER LINE PRIOR TO TESTING, ETC., MUST BE PROVIDED WITH AT LEAST A 50mm (2") OUTLET ON 100mm (4") AND LARGER LINES. COPPER LINES ARE TO HAVE FLUSHING POINTS AT THE END, THE SAME SIZE AS THE LINE. THEY MUST ALSO BE HOSED OR PIPED TO ALLOW THE WATER TO DRAIN ONTO A PARKING LOT OR DOWN A DRAIN. ON FIRE LINES, FLUSHING OUTLET TO BE 100mm (4") DIAMETER MINIMUM ON A HYDRANT.
 - ALL CURB STOPS TO BE 3.0m (10') IF THE FACE OF THE BUILDING UNLESS OTHERWISE NOTED.
 - HYDRANT AND VALVE SET TO REGION STANDARD 1-6-1 DIMENSIONS A AND B, 0.7m (2') AND 0.9m (3') AND HAVE PUMPER NOZZLE.
 - WATERMANS TO BE INSTALLED TO GRADES AS SHOWN ON APPROVED SITE PLAN. COPY OF GRADE SHEETS MUST BE SUPPLIED TO INSPECTOR PRIOR TO COMMENCEMENT OF WORK, WHERE REQUESTED BY INSPECTOR.
 - WATERMANS MUST HAVE A MINIMUM VERTICAL CLEARANCE OF 0.3m (12") OVER 0.5m (20") UNDER SEWERS AND ALL OTHER UTILITIES WHEN CROSSING. ALL PROPOSED WATER PIPING MUST BE ISOLATED FROM EXISTING LINES IN ORDER TO ALLOW INDEPENDENT PRESSURE TESTING AND CHLORINATING FROM EXISTING SYSTEMS.
 - ALL LIVE TAPPING AND OPERATION OF REGION WATER VALVES SHALL BE ARRANGED THROUGH THE REGIONAL INSPECTOR ASSIGNED OR BY CONTACTING THE OPERATIONS AND MAINTENANCE DIVISION.
 - LOCATION OF ALL EXISTING UTILITIES IN THE FIELD TO BE ESTABLISHED BY THE CONTRACTOR.
 - THE CONTRACTOR(S) SHALL BE SOLELY RESPONSIBLE FOR LOCATES, EXPOSING, SUPPORTING AND PROTECTING OF ALL UNDERGROUND AND OVERHEAD UTILITIES AND STRUCTURES EXISTING AT THE TIME OF CONSTRUCTION IN THE AREA OF THEIR WORK, WHETHER SHOWN ON THE PLANS OR NOT AND FOR ALL REPAIRS AND CONSEQUENCES RESULTING FROM DAMAGE TO SAME.
 - THE CONTRACTOR(S) SHALL BE SOLELY RESPONSIBLE TO GIVE 72 HOURS WRITTEN NOTICE TO THE UTILITIES PRIOR TO CROSSING SUCH UTILITIES, FOR THE PURPOSE OF INSPECTION BY THE CONCERNED UTILITY. THIS INSPECTION WILL BE FOR ALL COSTS ARISING FROM SUCH INSPECTION.
 - ALL PROPOSED WATER PIPING MUST BE ISOLATED THROUGH A TEMPORARY CONNECTION THAT SHALL INCLUDE AN APPROPRIATE CROSS-CONNECTION CONTROL DEVICE, CONSISTENT WITH THE DEGREE OF HAZARD, FOR BACKFLOW PREVENTION OF THE ACTIVE DISTRIBUTION SYSTEM, CONFORMING TO REGION OF PEEL STANDARDS 1-7-7 OR 1-7-8.

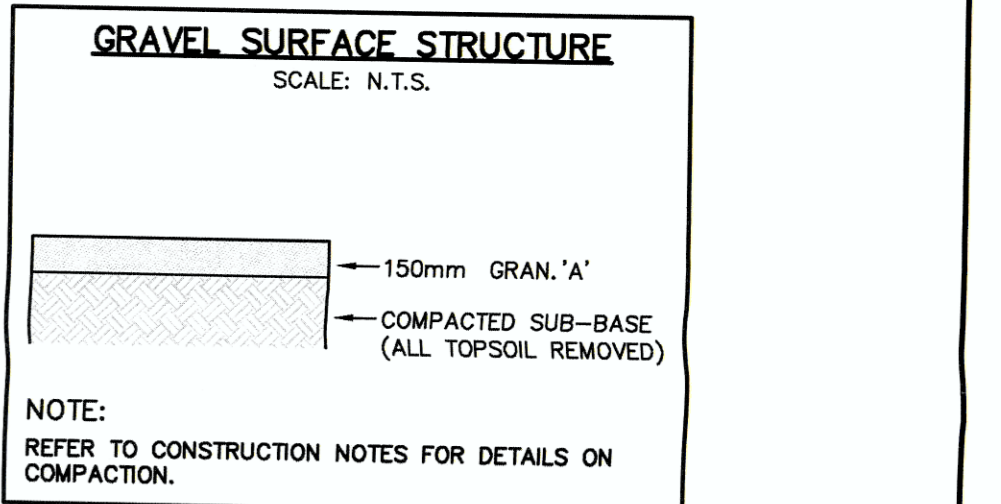
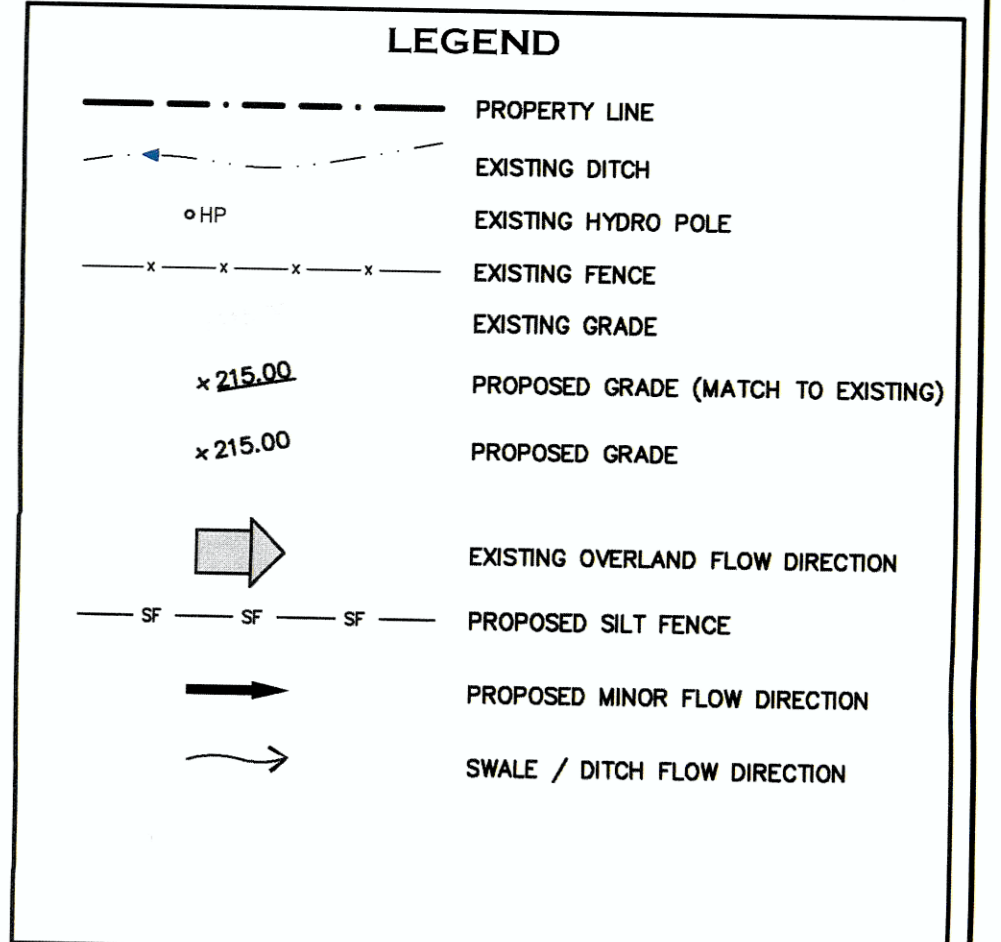
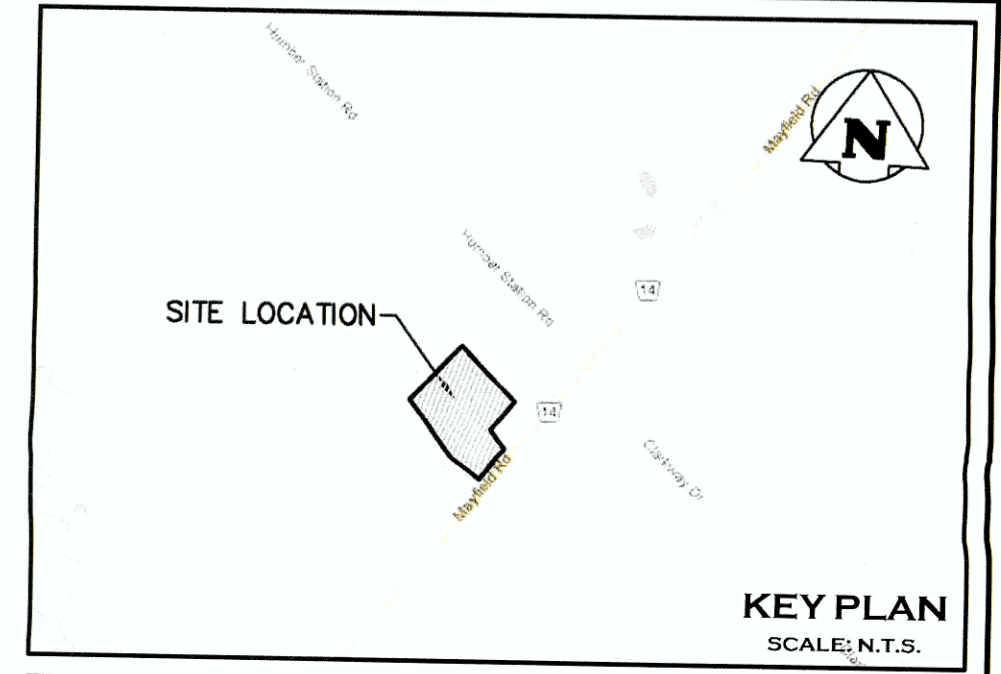

| | | |
|-----|-------------------------------|------------|
| 3 | RE-ISSUED FOR SPA | 2017/03/01 |
| 2 | RE-ISSUED FOR SPA | 2016/10/28 |
| 1 | RE-ISSUED FOR SPA | 2016/03/24 |
| 0 | ISSUED FOR 1st SUBMISSION SPA | 2015/06/22 |
| No. | ISSUE / REVISION | YYYY/MM/DD |

ELEVATION NOTE:
ELEVATIONS SHOWN ON THIS PLAN ARE DERIVED FROM THE TOWN OF CALEDON BENCHMARK No. 40, HAVING A PUBLISHED ELEVATION OF 222.165 METERS.

SURVEY NOTES:
SURVEY COMPLETED BY ALLIANCE SURVEYS INC. ON THE 9TH DAY OF MARCH, 2012. REFERENCE No. 12-4004.
LEGAL INFORMATION TAKEN FROM SURVEY PLAN BY H. PILLER CORP. INC. DATED OCTOBER 17, 2008.
DISTANCES ARE GROUND AND CAN BE CONVERTED TO GRID BY MULTIPLYING BY THE COMBINED SCALE FACTOR OF 0.9998781.

SITE PLAN NOTE:
SITE PLAN PREPARED BY WESTON CONSULTING, DATED AUGUST, 11 2016

DRAWING NOTES:
THIS DRAWING IS THE EXCLUSIVE PROPERTY OF C.F. CROZIER & ASSOCIATES INC. AND THE REPRODUCTION OF ANY PART WITHOUT PRIOR WRITTEN CONSENT OF THIS OFFICE IS STRICTLY PROHIBITED.
THE CONTRACTOR SHALL VERIFY ALL DIMENSIONS, LEVELS, AND DATUMS ON SITE AND REPORT ANY DISCREPANCIES OR OMISSIONS TO THIS OFFICE PRIOR TO CONSTRUCTION.
THIS DRAWING IS TO BE READ AND UNDERSTOOD IN CONJUNCTION WITH ALL OTHER PLANS AND DOCUMENTS APPLICABLE TO THIS PROJECT. DO NOT SCALE THIS DRAWING.
ALL EXISTING UNDERGROUND UTILITIES TO BE VERIFIED IN THE FIELD BY THE CONTRACTOR PRIOR TO CONSTRUCTION.

Project
7904 MAYFIELD ROAD
TOWN OF CALEDON

Drawing
GRADING PLAN
MAYFIELD ROAD

Engineer
CROZIER & ASSOCIATES ENGINEERS
2800 HIGH POINT DRIVE SUITE 100 MILTON, ON L9T 6P4 905-875-0026 T 905-875-4915 F WWW.CFCROZIER.CA

Drawn J.O./M.M. Design R.A.A./A.S. Project No. **612-3293**
Check J.R.S. Check N.C. Scale 1:250 Dwg. **C 03**

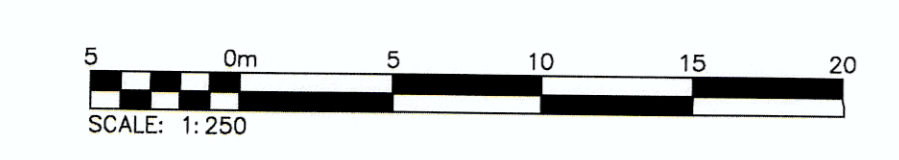
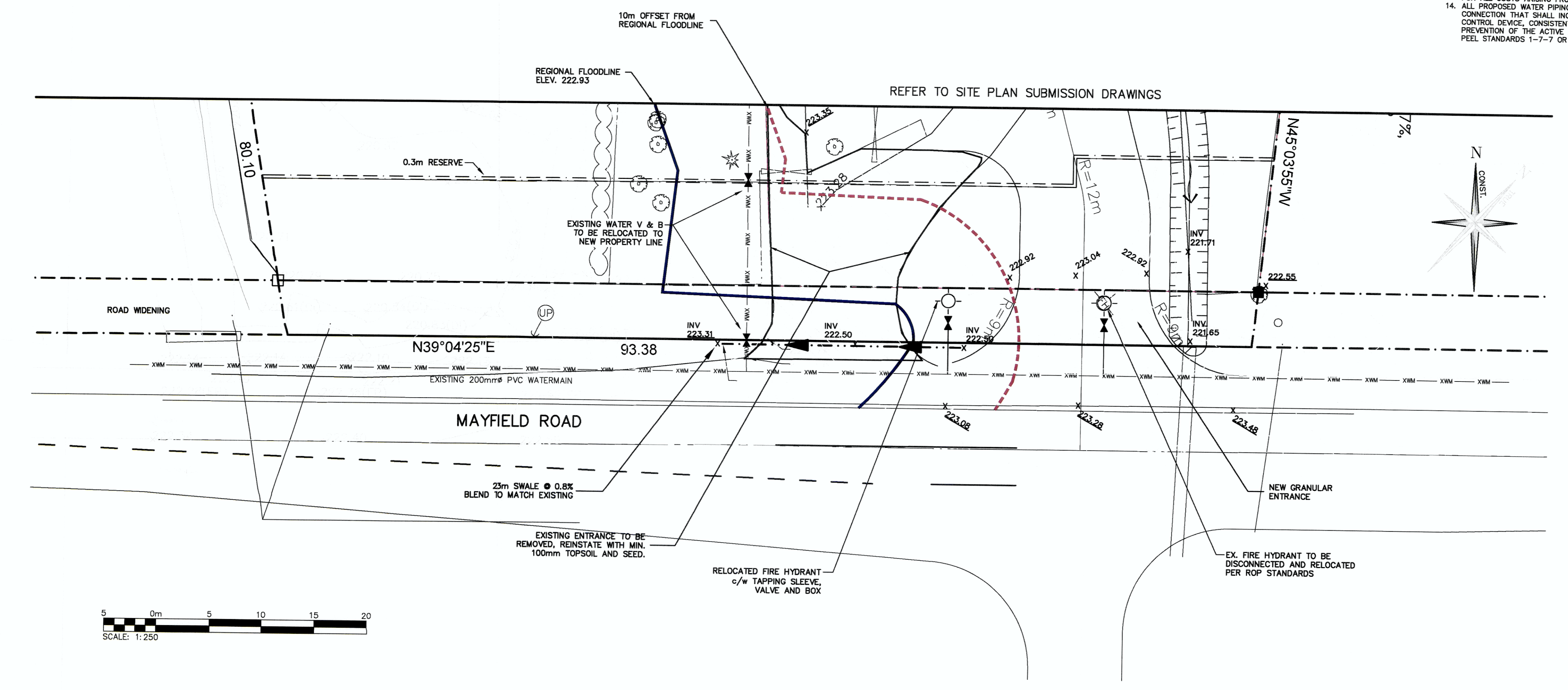

TOWN OF CALEDON
Site Plan Approved
As of: Feb. 6/18
FILE No. SPA 15-30
Melissa Mark
Lead Planner

RECEIVED
AUG 8 2017
PLANNING DEPARTMENT

TOWN OF CALEDON
PLANNING
RECEIVED
September 11, 2024

ENGINEER
C.F. CROZIER
100651476
March 11/17
PROVINCE OF ONTARIO

SPA #15-30