

- SPECIFICATIONS FOR THE PROTECTION AND PRESERVATION OF EXISTING VEGETATION
- PRIOR TO ISSUANCE OF THE BUILDING PERMIT, ALL EXISTING TREES THAT ARE TO BE PRESERVED SHALL BE FULLY PROTECTED WITH HOARDING OR SNOW FENCING OUTSIDE THEIR DRIPLENES TO THE SATISFACTION OF THE TOWN.
 - GROUPS OF TREES AND OTHER EXISTING PLANTINGS TO BE PROTECTED SHALL BE TREATED IN A LIKE MANNER WITH HOARDING AROUND THE ENTIRE CLUMBS.
 - AREAS WITHIN THE PROTECTIVE FENCING SHALL REMAIN UNDISTURBED AND SHALL NOT BE USED FOR THE STORAGE OF BUILDING MATERIAL OR EQUIPMENT NO CONTAMINANTS SHALL BE DUMPED OR FLUSHED WHERE FEEDER ROOTS OF TREES EXIST.
 - PRUNE BRANCHES TO REMOVE DAMAGED LIMBS ONLY. DO NOT DAMAGE LEADERS. ALL CUTS OVER 50mm SHALL BE TREATED IN ACCORDANCE WITH APPROPRIATE HORTICULTURAL PRACTICES AS APPROVED BY THE TOWN.
 - CUTTING OF ROOTS OR CHANGING OF GRADES AROUND EXISTING TREES TO BE PRESERVED WILL NOT BE PERMITTED WITHOUT THE APPROVAL OF THE PUBLIC WORKS AND ENGINEERING DEPARTMENT.
 - TREES THAT HAVE DIED, OR HAVE BEEN DAMAGED BEYOND REPAIR SHALL BE REPLACED AT THE DEVELOPER'S EXPENSE, WITH TREES OF A SIZE AND SPECIES APPROVED BY THE TOWN TO THE SATISFACTION OF THE TOWN.
 - A WATERING AND FERTILIZING PROGRAM IS TO BE SET UP TO THE SATISFACTION OF THE TOWN.
 - TREE PRESERVATION FENCE TO BE INSPECTED BY THE CONSULTING LANDSCAPE ARCHITECT AND APPROVED PRIOR TO CONSTRUCTION COMMENCING.

TOWN OF CALEDON		APRD. C.C.	DATE: JUNE 08
2	STANDARD No. 1135 NOV 107, NOTES EDT	JUNE 08	DRAWN: abal
1	NOTE NO. 9 ADDED	MARCH 06	SCALE: NTS
TREE PRESERVATION		STANDARD No. 707	
NO.	REVISION	APRD	DATE

1 TREE PROTECTION HOARDING

Tag No.	Tree Species	Diameter (cm)	Crown Dia. (m)	GFIP	Health	Structure	Comments	Action	Minimum	Tag No.
60	WALNUT	41	17	GOOD	GOOD	GOOD	CROWDED BY ADJACENT TREES. MINOR DEADWOOD.	PRESERVE	3	60
61	MANITоба MAPLE	63	13	FAIR	POOR	POOR	SLIGHT LEAN. LARGE HANGER IN CANOPY. MAJOR DEADWOOD. NATURALIZED. CROWDED BY ADJACENT TREES.	PRESERVE	4.2	61
62	WALNUT	30	8	GOOD	FAIR	FAIR	HIGH CROWN. MINOR DEADWOOD. CROWDED BY ADJACENT TREES.	REMOVE	NA	62
63	WALNUT	35	8	GOOD	FAIR	FAIR	HIGH CROWN. MINOR DEADWOOD. CROWDED BY ADJACENT TREES.	REMOVE	NA	63
64	MANITоба MAPLE	28	6	POOR	POOR	POOR	MAIN STEMS FAILED. HEAVY LEAN. MAJOR DEADWOOD. CROWDED BY ADJACENT TREES.	REMOVE	NA	64
65	WALNUT	32	5	GOOD	FAIR	FAIR	HIGH CROWN. THIN CROWN. MINOR DEADWOOD. CROWDED BY ADJACENT TREES.	REMOVE	NA	65
66	MANITоба MAPLE	29	6	FAIR	FAIR	FAIR	NATURALIZED. STEM FAILURE AT BASE. MAJOR DEADWOOD. CROWDED BY ADJACENT TREES.	REMOVE	NA	66
67	MANITоба MAPLE	20	3	POOR	POOR	POOR	DAMAGED TOP. CROWDED BY ADJACENT TREES. NATURALIZED. MAJOR DEADWOOD.	REMOVE	NA	67
68	MANITоба MAPLE	22	3	POOR	POOR	POOR	FAILED. MAJOR DEADWOOD. NATURALIZED. MAJOR DEADWOOD.	REMOVE	NA	68
69	WALNUT	33	6	GOOD	GOOD	GOOD	HIGH CROWN. MINOR DEADWOOD. CROWDED BY ADJACENT TREES.	REMOVE	NA	69
70	MANITоба MAPLE	75	9	POOR	POOR	POOR	FAILED. MAJOR DEADWOOD. NATURALIZED. LARGE SUCKER GROWTH AT BASE.	REMOVE	NA	70
71	MANITоба MAPLE	54	8	POOR	POOR	POOR	FAILED. MAJOR DEADWOOD. NATURALIZED. LARGE SUCKER GROWTH AT BASE.	REMOVE	NA	71
72	WALNUT	24	6	FAIR	FAIR	FAIR	HIGH CROWN. CROWDED BY ADJACENT TREES. COVERED IN VINES. MINOR DEADWOOD.	REMOVE	NA	72
73	BASSWOOD	59	6	FAIR	FAIR	FAIR	CROWDED BY ADJACENT TREES. MINOR DEADWOOD.	REMOVE	NA	73
74	MANITоба MAPLE	29	4	GOOD	FAIR	FAIR	CROWDED BY ADJACENT TREES. MINOR DEADWOOD. NATURALIZED.	REMOVE	NA	74
75	BASSWOOD	27	5	FAIR	FAIR	FAIR	CROWDED BY ADJACENT TREES. MINOR DEADWOOD.	REMOVE	NA	75
76	MANITоба MAPLE	24	4	POOR	POOR	POOR	CROWDED BY ADJACENT TREES. MINOR DEADWOOD. NATURALIZED.	REMOVE	NA	76
77	BASSWOOD	10/20/20	9	FAIR	FAIR	FAIR	CROWDED BY ADJACENT TREES. MINOR DEADWOOD. CO-DOMINANT STEMS.	REMOVE	NA	77
78	MANITоба MAPLE	19/20	5	POOR	POOR	POOR	SLIGHT LEAN. MINOR DEADWOOD. CROWDED BY ADJACENT TREES. NATURALIZED.	REMOVE	NA	78
79	MANITоба MAPLE	19/18/21/21	6	POOR	POOR	POOR	CO-DOMINANT STEMS. MINOR DEADWOOD. CROWDED BY ADJACENT TREES. NATURALIZED.	REMOVE	NA	79
80	WALNUT	37	5	FAIR	FAIR	FAIR	CROWDED BY ADJACENT TREES. MINOR DEADWOOD.	REMOVE	NA	80
81	WALNUT	21	8	FAIR	FAIR	FAIR	CROWDED BY ADJACENT TREES. MINOR DEADWOOD.	REMOVE	NA	81
82	NORWAY MAPLE CRIMSON KING	30	6	GOOD	GOOD	GOOD	MINOR DEADWOOD. THIN CANOPY.	REMOVE	NA	82
83	WALNUT	30	13	GOOD	GOOD	GOOD	NATURALIZED. MINOR DEADWOOD.	REMOVE	NA	83
84	NORWAY MAPLE	34	8	FAIR	FAIR	FAIR	MAJOR DEADWOOD. WOUND ON MAIN TRUNK. MINOR DEADWOOD.	REMOVE	NA	84
85	SILVER MAPLE	54	6	FAIR	FAIR	FAIR	MINOR DEADWOOD. CROWDED BY ADJACENT TREES.	REMOVE	NA	85
86	WALNUT	28	6	FAIR	FAIR	FAIR	MINOR DEADWOOD. CANOPY TO THE GROUND. CROWDED BY ADJACENT TREE.	REMOVE	NA	86
87	SILVER MAPLE	20	6	FAIR	FAIR	FAIR	MINOR DEADWOOD. THIN CROWN. CROWDED BY ADJACENT TREE.	REMOVE	NA	87
88	WALNUT	24	6	GOOD	GOOD	GOOD	MINOR DEADWOOD. CANOPY TO THE GROUND. CROWDED BY ADJACENT TREE.	REMOVE	NA	88
89	MANITоба MAPLE	67	19	FAIR	FAIR	FAIR	NATURALIZED. MINOR DEADWOOD.	REMOVE	NA	89
90	BIRCH	16/37	8	FAIR	FAIR	FAIR	MINOR DEADWOOD. THIN CROWN. CROWDED BY ADJACENT TREE.	REMOVE	NA	90
91	BLACK LOCUST	96	10	GOOD	FAIR	FAIR	CO-DOMINANT STEMS. MINOR DEADWOOD. CROWDED BY ADJACENT TREES. NATURALIZED.	REMOVE	NA	91
92	POPULAR	75	14	FAIR	POOR	POOR	HEAVY LEAN. CROWDED BY ADJACENT TREES. MAJOR DEADWOOD.	REMOVE	NA	92
93	SIBERIAN ELM	17	5	FAIR	FAIR	FAIR	CROWDED BY ADJACENT TREE. MINOR DEADWOOD. NATURALIZED.	REMOVE	NA	93
94	BLACK LOCUST	20/33	5	FAIR	FAIR	FAIR	MINOR DEADWOOD. CROWDED BY ADJACENT TREES.	REMOVE	NA	94
95	NORWAY MAPLE	20	5	FAIR	FAIR	FAIR	MINOR DEADWOOD.	REMOVE	NA	95
96	COLORADO SPRUCE	20	4	FAIR	FAIR	FAIR	MINOR INNER DEADWOOD. CROWDED BY ADJACENT TREES.	REMOVE	NA	96
97	MANITоба MAPLE	24/27	3	POOR	POOR	POOR	HEAVY LEAN. CROWDED BY ADJACENT TREES. MAJOR DEADWOOD. BROKEN TOP.	REMOVE	NA	97
98	BLACK LOCUST	17	9	FAIR	FAIR	FAIR	CROWDED BY ADJACENT TREES. MINOR DEADWOOD. HIGH CROWN.	REMOVE	NA	98
99	COLORADO SPRUCE	24	6	GOOD	GOOD	GOOD	MINOR INNER DEADWOOD. CROWDED BY ADJACENT TREES.	REMOVE	NA	99
100	COLORADO SPRUCE	20	8	GOOD	GOOD	GOOD	MINOR INNER DEADWOOD. CROWDED BY ADJACENT TREES.	REMOVE	NA	100
101	COLORADO SPRUCE	37	6	GOOD	GOOD	GOOD	MINOR INNER DEADWOOD. CROWDED BY ADJACENT TREES.	REMOVE	NA	101
102	COLORADO SPRUCE	28	6	GOOD	GOOD	GOOD	MINOR INNER DEADWOOD. CROWDED BY ADJACENT TREES.	REMOVE	NA	102
103	COLORADO SPRUCE	30	5	GOOD	GOOD	GOOD	MINOR INNER DEADWOOD. CROWDED BY ADJACENT TREES.	REMOVE	NA	103
104	AUSTRIAN PINE	39	7	GOOD	GOOD	GOOD	MINOR INNER DEADWOOD. CROWDED BY ADJACENT TREES.	REMOVE	NA	104
105	AUSTRIAN PINE	35	7	GOOD	GOOD	GOOD	MINOR INNER DEADWOOD. CROWDED BY ADJACENT TREES.	REMOVE	NA	105
106	AUSTRIAN PINE	39	7	GOOD	GOOD	GOOD	MINOR INNER DEADWOOD. CROWDED BY ADJACENT TREES.	REMOVE	NA	106
107	MANITоба MAPLE	26/20/26	6	FAIR	FAIR	FAIR	CO-DOMINANT STEMS. MINOR DEADWOOD. CROWDED BY ADJACENT TREES. NATURALIZED.	REMOVE	NA	107
108	BASSWOOD	12/18/24/32	12	FAIR	POOR	POOR	CO-DOMINANT STEMS. MINOR DEADWOOD. CROWDED BY ADJACENT TREES. NATURALIZED.	REMOVE	NA	108
109	BASSWOOD	36/38	12	FAIR	FAIR	FAIR	CO-DOMINANT STEMS. MINOR DEADWOOD. CROWDED BY ADJACENT TREES. NATURALIZED.	REMOVE	NA	109
110	MILLBERRY	78	11	POOR	POOR	POOR	MINOR DEADWOOD THROUGHOUT CANOPY. WOUND ON TRUNK. TREE IN DECLINE. THIN CROWN.	REMOVE	NA	110
111	COLORADO SPRUCE	23	6	GOOD	GOOD	GOOD	MINOR INNER DEADWOOD. CROWDED BY ADJACENT TREES.	REMOVE	NA	111
112	COLORADO SPRUCE	22	5	GOOD	GOOD	GOOD	MINOR INNER DEADWOOD. CROWDED BY ADJACENT TREES.	REMOVE	NA	112
113	CEDAR	38	3	POOR	POOR	POOR	HIGH CROWN. POORLY PRUNED. TREE IN DECLINE. MINOR DEADWOOD.	REMOVE	NA	113
114	CEDAR	42	6	FAIR	FAIR	FAIR	MINOR INNER DEADWOOD. CROWDED BY ADJACENT TREES.	PRESERVE	3	114
115	CEDAR HEADGE ROW (20 STEMS)	20/35	5	FAIR	FAIR	FAIR	TIGHTLY PACKED CEDARS. MINOR INNER DEADWOOD. CROWDED TOGETHER. SOME ARE LEANING.	PRESERVE	2.4	115
116	HORSECHESNUT	42/95	9	FAIR	FAIR	FAIR	CO-DOMINANT STEMS. MINOR DEADWOOD. CROWDED BY ADJACENT TREES.	PRESERVE	8	116
117	HEDGE ROW (MIXED CONIFERS)	20-42	6	GOOD	GOOD	GOOD	MIX OF SPRUCE AND PINE. TIGHTLY PLANTED TOGETHER TO FORM A HEDGE. MINOR INNER DEADWOOD. CROWDED BY NEIGHBORING TREES.	PRESERVE	3	117
118	SCOT PINE	32	6	GOOD	GOOD	GOOD	MINOR DEADWOOD.	REMOVE	NA	118

THE KING'S HIGHWAY No. 10

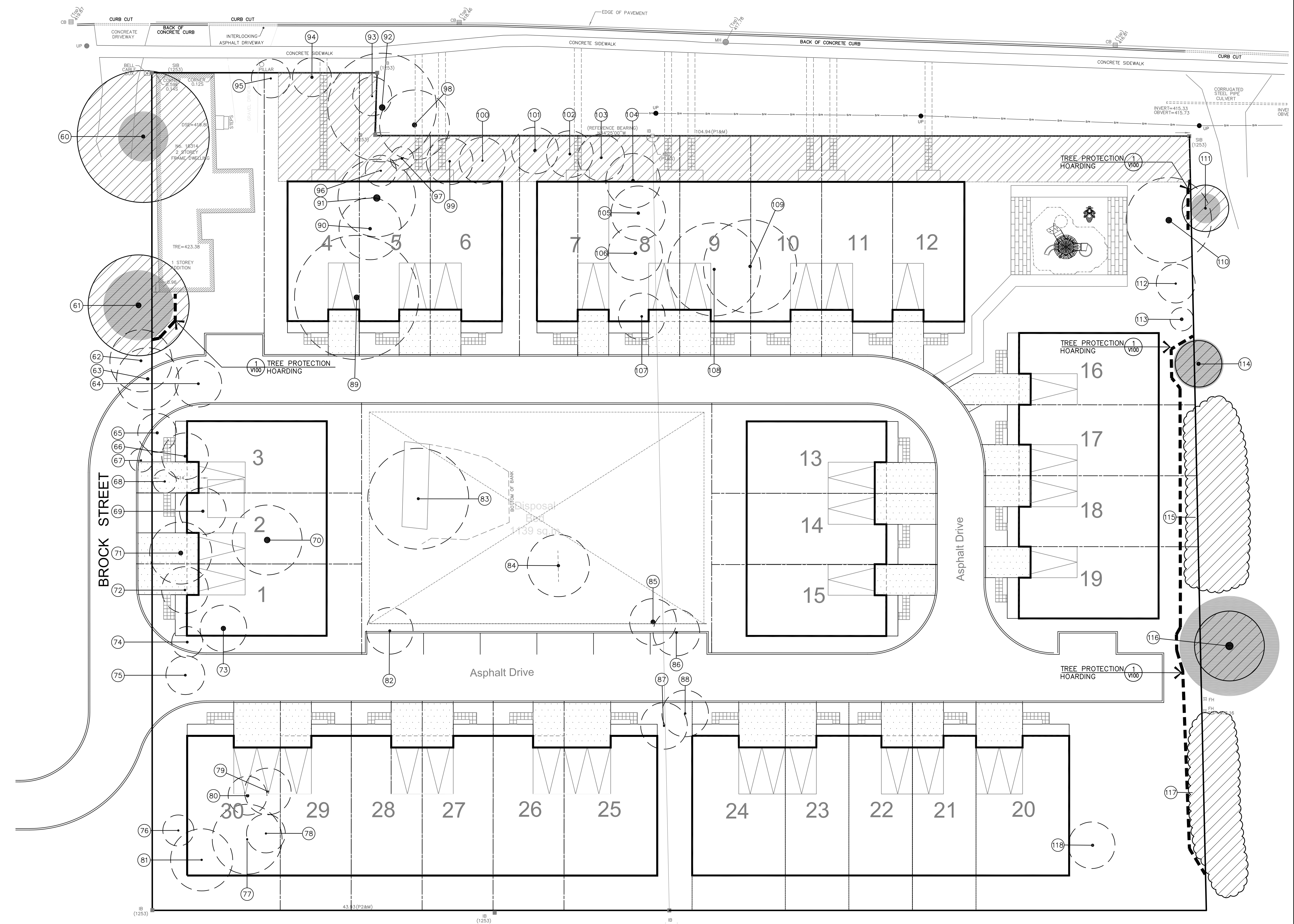

GENERAL NOTES

- VERIFY ALL DIMENSIONS.
- DO NOT SCALE DRAWINGS.
- REPORT ANY DISCREPANCIES, DISCOVERED ERRORS, OR OMISSIONS TO THE LANDSCAPE ARCHITECT BEFORE PROCEEDING.
- IT IS ADVISED THAT CONTRACTORS CONTACT THE LANDSCAPE ARCHITECT PRIOR TO CONSTRUCTION TO ENSURE THE USE OF THE LATEST REVISED DRAWINGS.
- DRAWINGS AND SPECIFICATIONS ARE THE PROPERTY OF THE LANDSCAPE ARCHITECT.

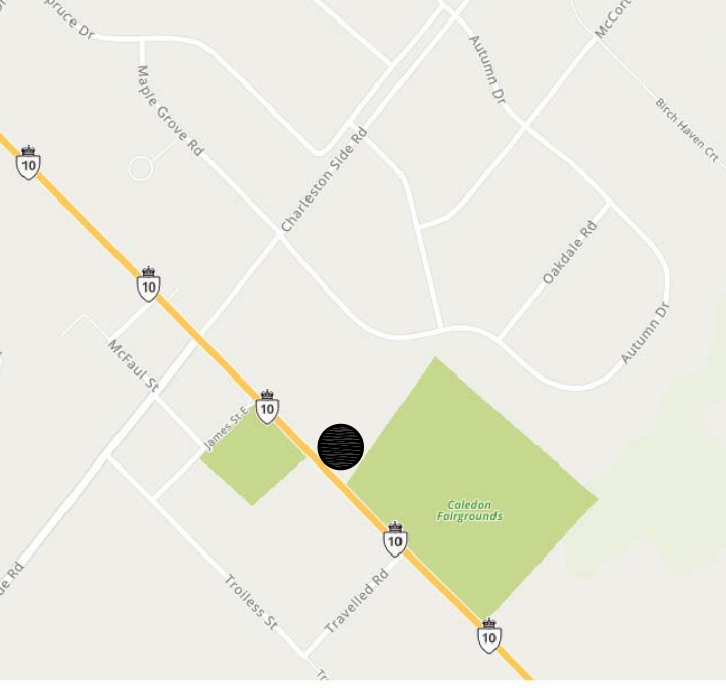

KEY MAP LEGEND

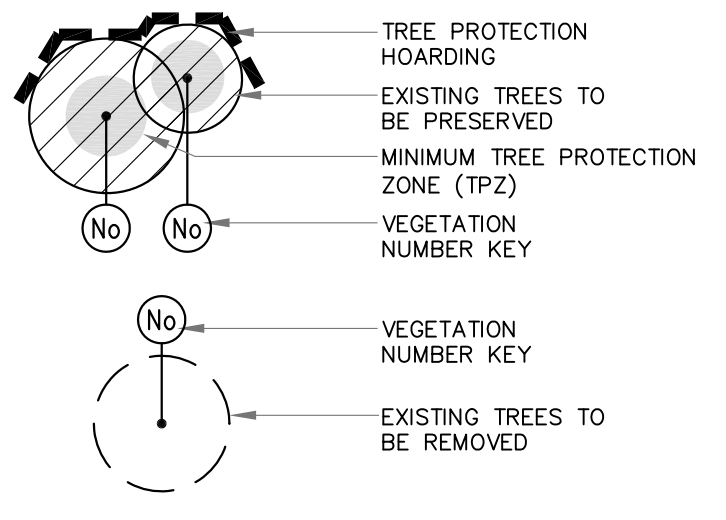

Matthew C. Goffres
 MATTHEW C. GOFFRES
 International Society of Arboriculture
 Certified Arborist #0N-1114A
 Date: DEC. 11, 2020

1	DEC. 11/2020	ISSUED FOR SUBMISSION	JOB
No.	DATE	REVISION	BY

It is the responsibility of the Contractor and/or Owner to ensure that the drawings with the latest revisions are used for construction.

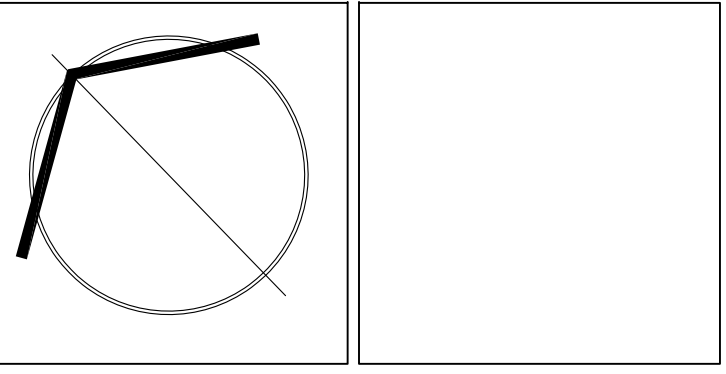

5770 HURONTARIO STREET, SUITE 320
 MISSISSAUGA, ONTARIO, L5R 3G5
 T: 416.695.4949 F: 905.712.3101
 WWW.STRYBOS.COM

PROJECT:
PROPOSED TOWNHOUSE DEVELOPMENT
 18314 & 18309 HURONTARIO STREET
 TOWN OF CALEDON, ONTARIO
 MILANI GROUP

DRAWING TITLE:
EXISTING TREE INVENTORY AND PRESERVATION PLAN

SCALE:	1 : 250	PROJECT No.	19-5402
DATE:	AUG. 2020	DRAWING No.	V100
DRAWN BY:	H.S.	CHECKED BY:	B.B.