

TOTAL HARD PAVING AREA = 3,633.03 m²
 (PRIVATE ROAD/PARKING/TRAIL AREA)

PROPOSED SNOW STORAGE AREA = 394.04 m²
 (10.76% of Total Hard Paving Area)

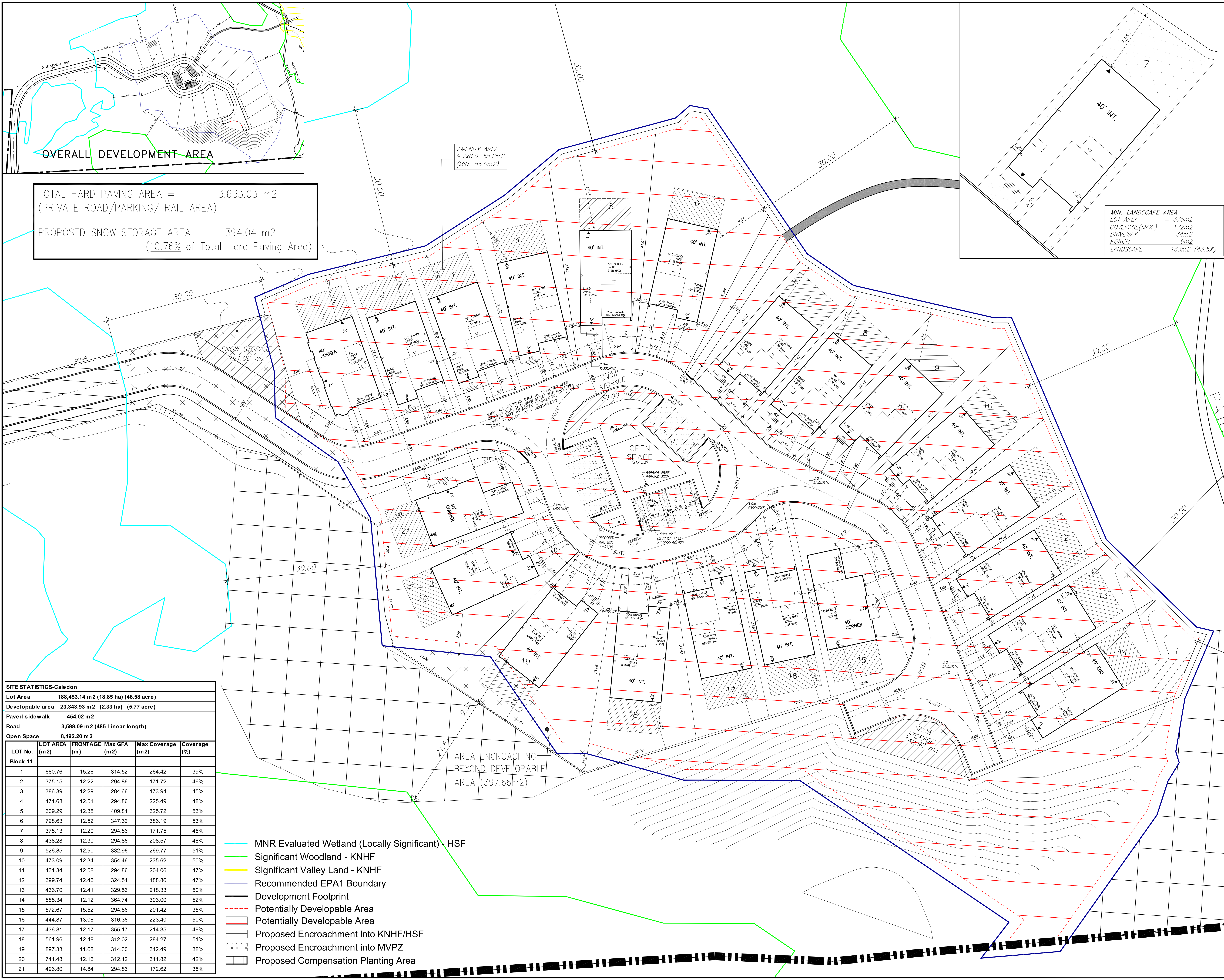
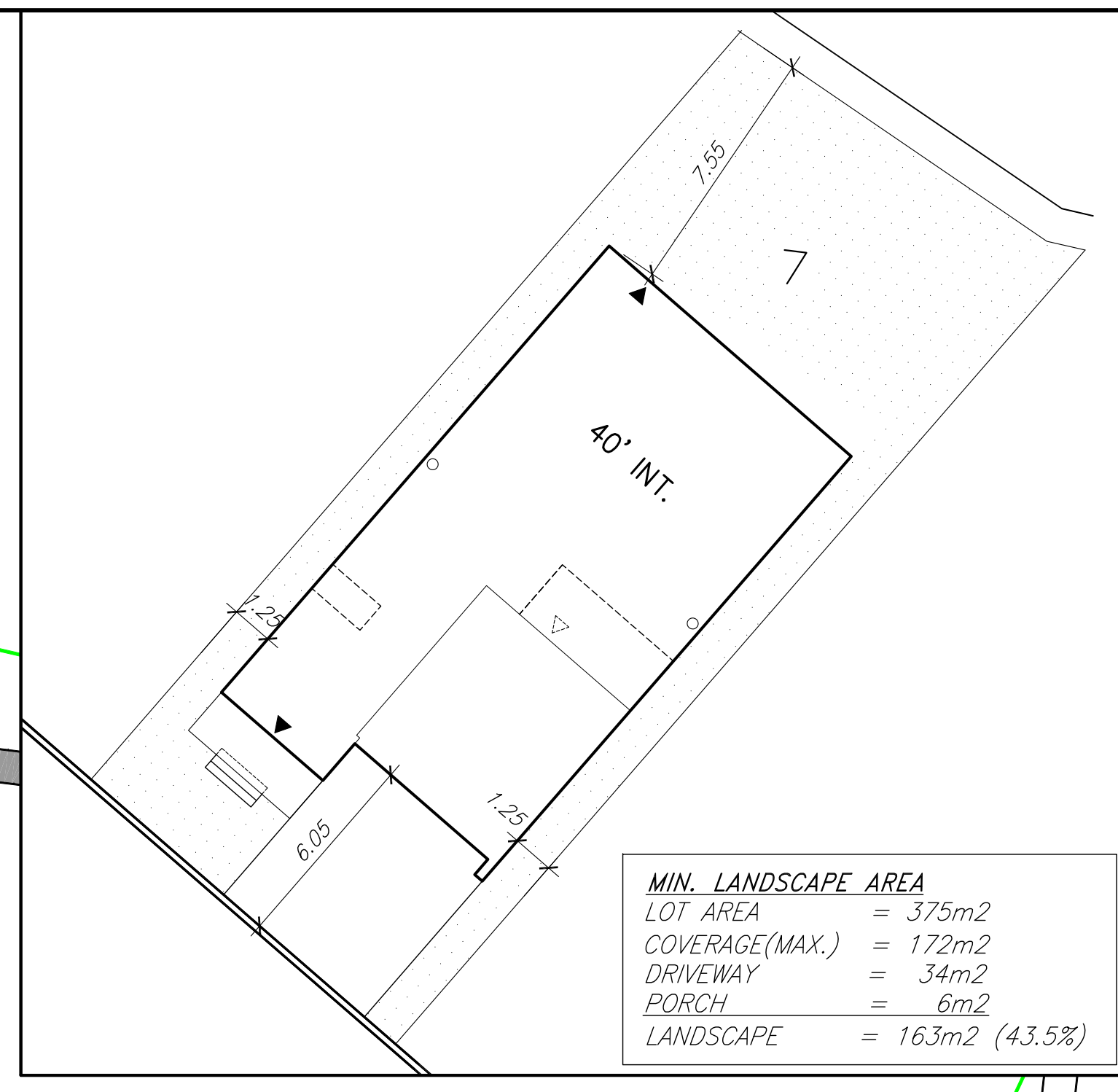

SITE STATISTICS-Caledon

| | |
|------------------|---|
| Lot Area | 188,453.14 m ² (18.85 ha) (46.58 acre) |
| Developable area | 23,343.93 m ² (2.33 ha) (5.77 acre) |
| Paved sidewalk | 454.02 m ² |
| Road | 3,588.09 m ² (485 Linear length) |
| Open Space | 8,492.20 m ² |

| LOT No. | LOT AREA (m ²) | FRONTAGE (m) | Max GFA (m ²) | Max Coverage (m ²) | Coverage (%) |
|----------|----------------------------|--------------|---------------------------|--------------------------------|--------------|
| Block 11 | | | | | |
| 1 | 680.76 | 15.26 | 314.52 | 264.42 | 39% |
| 2 | 375.15 | 12.22 | 294.86 | 171.72 | 46% |
| 3 | 386.39 | 12.29 | 284.66 | 173.94 | 45% |
| 4 | 471.68 | 12.51 | 294.86 | 225.49 | 48% |
| 5 | 609.29 | 12.38 | 409.84 | 325.72 | 53% |
| 6 | 728.63 | 12.52 | 347.32 | 386.19 | 53% |
| 7 | 375.13 | 12.20 | 294.86 | 171.75 | 46% |
| 8 | 438.28 | 12.30 | 294.86 | 208.57 | 48% |
| 9 | 526.85 | 12.90 | 332.96 | 269.77 | 51% |
| 10 | 473.09 | 12.34 | 354.46 | 235.62 | 50% |
| 11 | 431.34 | 12.58 | 294.86 | 204.06 | 47% |
| 12 | 399.74 | 12.46 | 324.54 | 188.86 | 47% |
| 13 | 436.70 | 12.41 | 329.56 | 218.33 | 50% |
| 14 | 585.34 | 12.12 | 364.74 | 303.00 | 52% |
| 15 | 572.67 | 15.52 | 294.86 | 201.42 | 35% |
| 16 | 444.87 | 13.08 | 316.38 | 223.40 | 50% |
| 17 | 436.81 | 12.17 | 355.17 | 214.35 | 49% |
| 18 | 561.96 | 12.48 | 312.02 | 284.27 | 51% |
| 19 | 897.33 | 11.68 | 314.30 | 342.49 | 38% |
| 20 | 741.48 | 12.16 | 312.12 | 311.82 | 42% |
| 21 | 496.80 | 14.84 | 294.86 | 172.62 | 35% |

- MNR Evaluated Wetland (Locally Significant) - HSF
- Significant Woodland - KNHF
- Significant Valley Land - KNHF
- Recommended EPA1 Boundary
- Development Footprint
- Potentially Developable Area
- Potentially Developable Area
- Proposed Encroachment into KNHF/HSF
- Proposed Encroachment into MVPZ
- Proposed Compensation Planting Area

300A Wilson Avenue
 Toronto, ON M3H 1S8
 1 416 630 2255
 1 416 630 4782
 va3design.com

VAD DESIGN

24489
 42658

2031818 ONT. INC.

PT. W1/2 LOT 22 CON. 1

CALEDON ONTARIO

11/04/14

DATE: SEPTEMBER 2013

SCALE: 1:500

3