

CON. 6 W.H.S. (CAL)

BUSH ST

WINSTON CHURCHILL BLVD

SHAWS CREEK RD

THE GRANGE SDRD

LOT 10

LOT 9

LOT 8

LOT 7

LOT 6

This copy is provided for convenience only. If necessary, the original may be referred to in the office of the Town Clerk.

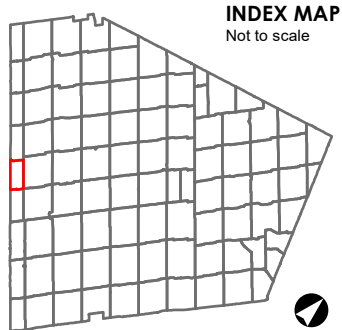

**A2** ZONE SYMBOL

**A2-###** ZONE SYMBOL

Note: Number of suffixes represent Exceptions which can be looked up in the Exceptions section of the By-law.

ZONE BOUNDARY

STRUCTURAL ENVELOPE MAP

NIAGARA ESCARPMENT DEVELOPMENT CONTROL AREA

Lands lying within the Development Control area pursuant to the Niagara Planning and Development Act are subject to permit requirements under Ontario Regulations 685/50, as amended.

OAK RIDGES MORaine CONSERVATION PLAN AREA BOUNDARY

**WELLHEAD PROTECTION AREA BOUNDARY**  
WP-2 WP-5 WP-10 WP-25  
Zone Maps amended to indicate the 2, 5, 10, and 25 year Wellhead Protection Areas.

BY-LAW 2006-50  
**ZONE MAP 54**  
SCHEDULE "A"

0 95 190 380 m



Date: 3 April 2006

Revised: August 21, 2015

File: S:\POLICY SECTION\GIS\zoning\_bylaw\2015\_mxd

54

The base data on this map is provided for convenience only. The Town of Caledon is not responsible for any deficiency or inaccuracy in the base data, and will not accept any liability whatsoever therefor. The reproduction of the base data, in whole or in part, by any means is prohibited without the prior written permission of the Town of Caledon.